

T.R.A.P

THEFT REDUCTION ACTION PROGRAM

During the previous two years the Mesa Police Department's Central Patrol Division's Community Action Team has been researching methods of creating an ultimate community-policing program for the City of Mesa's business community. At the same time, the Mesa Police Department was looking for a way to reduce patrol officer workloads without affecting the premiere service our business community has come to expect from the Mesa Police Department.

In April of 1999, the Mesa Police Department implemented the Theft Reduction Action Program (T.R.A.P) as a pilot program working with a selected retail store in the city. By August of 1999, the success of the program far surpassed all expectations - a 54 % reduction in officer response to shoplifting calls was achieved. Actual incidents of shoplifting **fell** by 21 %.

The Theft Reduction Action Program has been instituted citywide and is being shared with other law enforcement agencies in the state.



Mesa Police Department
130 N. Robson
Mesa, AZ. 85201

Community Action Team (C.A.T.)
Sgt. Jim Schweisthal
Officer Helen Simmonds

Acknowledgements

Wal-Mart at 1305 W. Main St., in Mesa, AZ. - this retail location allowed us to implement the pilot project in their store. Wal-Mart Manager Steve Curr was an integral part of the success of the program. He encouraged, cooperated, negotiated and provided vital resources to allow our Community Policing Officers to succeed. Steve shared the same enthusiasm and desire to make his store the safest retail outlet in the City as our officers had in implementing the Theft Reduction Action Program (T.R.A.P.).

A special thanks to the officers of the Mesa Police Department's **Central Patrol Division's Community Action Team** whose ideas and efforts made the program a success. **Officer Simmonds** was named as the Department's first T.R.A.P. officer. Since its inception, she has been a driving force behind the program, training civilians, handling the case load from the stores and establishing working relationships between all stake holders. She has provided training and assistance to other law enforcement departments throughout the Phoenix metropolitan area.

Chief Jan Strauss, Commanders Gil Otanez and Rick Clore, and Lieutenant John Pruitt have provided the encouragement, support, resources and enthusiasm to make the Theft Reduction Action Program a reality. Lieutenant Pruitt was instrumental in assisting with the formatting of the proposal and written documents needed to gain support from the Police Departmental Staff for the program. His knowledge of community policing and support for officers played a major role in the success of the program.

The Mesa Police Department's **Crime Analysis Unit** provided the data needed to determine the needs of our business community. The unit provided an instrument known as "The Top Fifteen Locations for Calls in the Districts." This was used to help the community action officers identify the need for a community policing approach for Mesa's business community.

Other retail stores in the City of Mesa have now joined the T.R.A.P. program. These stores include Target, Fry's, Sears, Mervyn's and Albertson's. We thank each of them for their desire to be part of this proactive community-policing program.

Finally, the **Mesa City Court** provided resources to make the Summons in Lieu of Citation portion of the program a success. Their efforts have helped reduce the workload of patrol officers who no longer need to respond to the majority misdemeanor shoplifting offenses. A special thanks to **Chief Prosecutor Lowell Hamilton** for his continued support.

To those individuals we may not have mentioned who have contributed to the success of this program, we extend our gratitude.

Table of Contents

Page	2 - 3	Abstract summary
Page	4 – 11	P.O.P. project
Page	12	Project contact people
Appendix	1	Original proposal
Appendix	2	Analysis of pilot project
Appendix	3	Statistics on shoplifting crimes in the City of Mesa
Appendix	4	Newspaper articles
Appendix	5	Complimentary letter from Walmart
Appendix	6	Top fifteen locations for calls for service
Appendix	7	T.R. A.P. questions and answer report
Appendix	8	Award for Wal-Mart's Steve Curry
Appendix	9	Officer Helen Simmond's - Elk's Mesa Officer of the Year.
Appendix	10	Shoplifting: The Billion Dollar Crime.

Theft Reduction Action Program

In the city of Mesa, Arizona the Mesa Police Department takes great pride in creating and implementing innovative strategies to deal with criminal activity in the city. Evidence of this commitment include programs such as the Crime Free Multi-Housing Program - an innovative plan to reduce crime in areas such as apartment complexes; the Crime Free Mini-Storage program; the Crime Free Motel/Hotel Program; the Crime Free Mobile Home Program - applications of the Crime Free Multi-Housing program to other community members; and The Center Against Family Violence - a community policing approach to preventing, detecting and prosecuting crimes involving family violence and sex crimes. Now, the Mesa Police Department can add yet another community policing success story to its accomplishments - **The Theft Reduction Action Program (T.R.A.P.)**.

The T.R.A.P. program is the result of the department's Central Patrol Division's Community Action Team (C.A.T.) seeking methods to better serve our business communities and reduce crimes related to the business communities in the city. The crimes that can occur at any business include murder, armed robbery, rape, kidnapping, car theft, car jackings, and purse thefts, forgeries and stolen credit card use. Theft is the crime of greatest frequency committed at business locations. The resulting loss to retail establishments nationwide exceeds 1 billion dollars a year. C.A.T. wanted to create a program that would assist the business community in reducing the amount of thefts they experienced.

The initial T.R.A.P. pilot project was implemented at a busy Wal-Mart store located in the west central portion of the city. The Wal-Mart is in a retail strip mall that is occupied by twelve small businesses (e.g., hair salon, sandwich shop and ice cream store, etc...). A major grocery store anchor shares the strip with the Wal-Mart. The strip mall is in an area of older hotels, a technical school, car dealers, boat dealer and other businesses. The Walmart is located on Main St. - a busy major east/west thoroughfare that virtually splits the city of Mesa in half from north to south.

The Wal-Mart was one of the areas in the entire Central Patrol Division that was consistently in the top three for numbers of calls for service at a given location. A three-month pilot project was conducted from May of 1999 to July of 1999. Upon completion of the pilot project, an over 50% reduction in police response to the store was accomplished. The Mesa Police Department had implemented a plan that empowered Walmart store loss prevention officers to capture more shoplifters, reduce the need for police response and establish a strong cooperative relationship between Walmart and the Mesa Police Department. The relationship became so strong that letters of gratitude were sent from Walmart's management to officers of the police department involved in T.R.A.P. In turn, Walmart's manager Steve Curry, who was instrumental in the implementation of the program, has received Mesa's Meritorious Service Award for a citizen, (see Appendix 8).

Since the completion of the pilot project in August of 1999, T.R.A.P. has expanded citywide in Mesa. Target, Kmart, Albertson's and Sears are some of the stores who have discovered the value of T.R.A.P. Officer Helen Simmonds is helping other departments in the Phoenix metropolitan area implement T.R.A.P. She has even received out of state inquiries.

Introduction

Mesa, Arizona is the third largest city in the State of Arizona with a population of over 407,000 people. Mesa is located east of the City of Phoenix and has a reputation of being a family oriented community. Mesa ranked as the fastest growing city in the United States for cities with populations in excess of 100,000 people in the 1990 Census and is the 46th largest city in the United States. Entrepreneur magazine ranked Mesa as one of the "Top Nine Cities to Start a Business" in its May 1992 issue.

The Mesa Police Department has 711 sworn police officers and 414 civilian employees. The Department's various units include narcotics, gang, motorcycle, air support, K-9, D.A.R.E., criminal investigations, bike, community relations and community policing teams.

The community policing initiative began in Mesa in 1990. During the early portion of the decade, Neighborhood Watch, Victim's Assistance and education on Problem Oriented Policing was the basis of community policing in Mesa. In 1993, the entire department would receive training in problem solving methods. This was the introduction of the Scanning, Analyze, Respond and Assess (S.A.R.A.) model to police officers in Mesa. Mesa would also turn back the hands of time in the early 90's and step away from the modern technology of the patrol unit and create a bike unit. Bringing officers closer to the public was a philosophy beginning to gain ground in Mesa.

In 1996, Mesa would establish a 13 member Community Action Team (two sergeants and eleven officers) whose function would be committed to problem solving. The funding for the unit came from the C.O.P.S. Ahead grants that the Federal government handed out to police agencies willing to establish community policing in their departments. The unit now stands at twenty officers and four supervisors. The units are split equally among the four police districts in the city. The focus of these Community Action Teams is city wide problem oriented policing.

The community policing mindset in Mesa has garnered significant recognition locally and nationwide. Established programs include the internationally known Crime Free Multi-Housing Program, Crime Free Hotel/Motel Program, Crime Free Mini-Storage Program, Crime Free Mobile Home Park Program, and the Crime Free Property Redistribution Program. Additionally, there are the Police Minority Relations, Center Against Family Violence, Neighborhood/Community Police Stations, Bike Units, Community Action Teams (C.A.T.) - formerly the community policing units, Cultural Diversity Team and now, the **Theft Reduction Action Program (T.R.A.P.)**.

Scanning

By 1997, the Mesa Police Department's community policing efforts had impacted virtually every segment of the city. The Community Action Teams were dealing with problems in neighborhoods, and finding viable solutions to issues brought to the attention of the Community Action Teams.

Through the Police Minority Relations initiative, officers were meeting with the minority populations at their churches. Police use of force discussions, gang education/prevention, youth programs and crime prevention was brought to the minority communities via the churches. Bike units were being used to patrol schools, business districts and neighborhoods. The Multi Crime Free Multi-Housing Program was helping to keep criminal activity in check at apartment complexes throughout the city. However, no *specific* community-policing program was in place to combat the criminal activity faced by our local business community.

In 1998, the Central Patrol Division's Community Action Team began to focus efforts on crime reduction at business locations throughout the Central district. Information was gathered to determine what types of crimes were committed at business locations. The main crime category was determined to be thefts. Thefts in the form of shoplifting, purse snatchings, auto thefts from the parking lots and employee theft. Theft of money from businesses by force or threatened use of force (extortion, robbery, and armed robbery) occurs within business communities throughout the nation, with Mesa being no exception.

Shoplifting and theft apprehensions were rarely made by a patrol officer witnessing a theft in progress at a retail establishment in the city. Loss prevention officers hired by the individual retail stores apprehend most shoplifters. They in turn notify the police who respond, and in most cases (misdemeanors) issue a citation to the suspect and send him/her on their way. The amount of time an officer took to handle the shoplifting could quickly reach between two and three hours. The loss prevention officer would also need to remain with the officer until the officer completed his/her part of the arrest. The Central Community Action Team was determined to find a more efficient process for the handling of theft cases, and minimize all forms of crime in our business community.

Analysis

During 1999, 2,236 shoplifting cases were reported to the Mesa Police Department 4,313 commercial thefts, 242 armed robberies, 698 forgeries and 685 credit card frauds. These are **reported crimes** only. Many thefts are not discovered until inventory checks are conducted. The actual number of thefts could be significantly higher.

An instrument entitled "*Top 15 Addresses for Calls for Service*" (see appendix 6), was created by the Mesa Police department's Crime Analysis Unit. Use of this instrument was an initial part of the analysis. The instrument listed the top fifteen addresses in each patrol district by the number of calls for service. [Note - during 1997, three patrol districts existed in Mesa.] In the Central district the Wal-Mart was consistently in the number one spot. When not in the number one spot it would occupy one of the top five spots.

The analysis of other district's top calls for service locations also had business communities at or near the top of the list. In the Dobson district, 1425 W. Southern listed in Appendix 6 is the Fiesta Mall - a large regional shopping center. In the Superstition district 6555 E. Southern is the Superstition Springs Mall, another large regional shopping center.

An officer who would respond to a call of a shoplifter in custody could spend an average of two to three hours on a call where an item worth \$20.00 was stolen. In the first quarter of 1999, Mesa patrol officers expended nearly 1100 man-hours (see last page of Appendix 1) on shoplifting in custody cases. This does not include court time if the defendant pled not guilty to the arrest.

During the analysis phase we also determined that certain business communities are populated throughout the day to the point they reach populations comparable to medium to large size cities. For example, the Walmart that was used for the pilot project would have an average of nearly 40,000 people pass through its doors during a one-week time frame. The Walmart is located in a plaza that contains restaurants, a major food chain and other specialty stores. Adding the stores together the one-week population could easily exceed 100,000 visitors, or an average of approximately 14,000 visitors per day. Mesa's two large malls during certain holidays could attract a million plus visitors during a week's time. An average week can range between a quarter million and a half million.

The numbers of individuals who frequent our business communities increases the potential for victimization to the businesses as well as the honest shopper. The types of individuals committing theft crimes in Mesa include juveniles, professional shoplifters, kleptomaniacs, impulse thieves and drug addicts. The drug addicts in Mesa are responsible for a significant portion of theft in the Mesa business communities. These individuals are involved in multiple crimes including shoplifting, credit card fraud, forgeries, fraud schemes, price switching, theft of checks and credit cards.

From an analysis of our arrest and interviews, we have also found that some of these individuals have crossed over into the category of professional criminals. One female suspect arrested by Officer Simmonds has been stealing from stores in the Valley of the Sun (Phoenix metropolitan area) for over six years, to the tune of over \$100,000 in stolen merchandise.

Analysis of the Traditional Response to Business Community Criminal Activity

The Mesa Police Department response to business community crime was a typical traditional reactive response prior to T.R.A.P. In the case of a shoplifting complaint Mesa would send an officer to take a police report. If a person was detained for a theft offense an officer would respond to issue a citation and, on some occasions (i.e., no identification, violent, warrants) the suspect would be taken into custody and booked at the Mesa City jail.

Retail stores that employed loss prevention officers would comment that the response time in Mesa was swift in comparison to other cities in the surrounding area. Mesa considers a person in custody as a priority one call. This status is just below an emergency response priority call. The call must be dispatched to a street officer within two minutes. In comparison several nearby cities would, at times, take in excess of two hours to respond an officer to a shoplifter in custody.

With the growth that is occurring in the City of Mesa it would be just a matter of time before Mesa would have to re-evaluate the need to send an officer expeditiously to a call involving a person in custody for the theft of a small dollar item. A plan was needed that could reduce the need for officers to respond to some in custody theft calls without reducing police service to the retail business community. The paradox became developing a plan that would decrease officer workload and increase the efficiency of the business community and police department to reduce crime.

RESPONSE

The response to the paradox mentioned in the analysis phase of this report is the **Theft Reduction Action Program**. The program is the brainchild of members of the Mesa Police Department's Central Division's Community Action Team. See Appendix 1 to view the official proposal for T.R.A.P. made to Mesa Police Staff.

The Goal of the Theft Reduction Action Program: To significantly reduce the need of patrol officers to respond to misdemeanor shoplifting calls while increasing the ability (empowerment) of business communities to reduce criminal activity on their properties.

The Theft Reduction Action Program (T.R.A.P.) consist of two components. Component one focuses on the empowerment of the retail stores to minimize crime at their stores. Component two is a method of reducing the need for officers to respond to misdemeanor shoplifting calls.

Component One: The Theft Reduction Action Plan

The Theft Reduction Action Plan has four core objectives:

1. Establish a strong working relationship with the business community.
2. Share intelligence information with loss prevention officers throughout the Phoenix metropolitan area.
3. A public relations campaign promoting the team effort between the Mesa Police Department and the business community (see Appendix 4).
4. Increased communication between the business community, community action officers, patrol officers, detectives and the Mesa City court system.

Component Two: Summons in Lieu of Citation

The Summons in Lieu of Citation (SILOC) allows a store loss prevention officer to complete the needed paperwork to have the suspect summons to court and answer to the shoplifting charge. A patrol beat officer no longer needs to respond to misdemeanor (total product value less than \$100.00) shoplifting cases if the suspect has no warrants, proper identification, not under the influence of any drugs and no physical force greater than passive resistance was used to affect the arrest.

This component of the program would allow the store's loss prevention officer to get back onto the floor immediately following the completion of his/her paperwork with the suspect without having to wait for the responding police officer. The Mesa Police

department T.R.A.P. officer picks up the store reports; reviews the cases to make sure the arrests are valid; and files the cases in the City Court. A summons is then issued for the defendant. Whether a patrol officer responds or the case is handled through SILOC, the end result is the same; the defendant receives a summons to appear in court.

Assessment

The Theft Reduction Action Program (T.R.A.P.) began a three-month pilot phase (see Appendix) on May 17, 1999. The pilot program was conducted at a Walmart located in the Central patrol district of the Mesa Police Department. The pilot project was a tremendous success. During the pilot project all objectives listed in the response section of this report were met. Officer Helen Simmonds, the first T.R.A.P. officer for the Mesa Police Department established a solid working relationship with the Wal-Mart that included the education of Wal-Mart employees in the area of crime prevention. She also met on a regular basis with loss prevention officers to share intelligence information. A strong working relationship was developed with criminal investigations, patrol and the Mesa Court.

Officer Simmonds held educational seminars for Wal-Mart employees that included the recognition of counterfeit money, credit card fraud and identifying drug suspects by the products they purchase. Officer Simmonds first seminar paid of immediately as a recently educated employee of Wal-Mart identified two individuals he observed purchasing Sudafed - ephedrine in Sudafed is a precursor chemical used in the manufacturing of the dangerous street drug methamphetamine. He notified Officer Simmonds who then provided the information to Mesa narcotic detectives. Subsequently, a dangerous methamphetamine lab was located and promptly dismantled.

Officer Simmonds also increased her skills in identifying the criminal element who frequent retail stores. While conducting a plain-clothes operation at a Target store in Mesa, Officer Simmonds observed two suspicious individuals in the store loading up a shopping cart with various items in a hurried manner. She had obtained intelligence information on individuals who would load up shopping carts and then exit the store to a waiting vehicle through an emergency exit in the rear of the store. The two suspects involved in this caper were arrested shortly after leaving the Target store for possession of stolen property, credit card fraud and narcotics possession. The manager in charge of the store on this date was overwhelmingly thankful for the services rendered by the Mesa Police Department.

Officer Simmonds has made numerous arrests of career type criminals working as a T.R.A.P. officer. One of the Benevolent Order of Elks chapters in Mesa was so impressed with her work they named Officer Simmonds the Mesa Elk's Officer of the Year (See Appendix 9).

Component two of the program was also deemed a tremendous success. The Summons in Lieu of Citation resulted in a 55% reduction in patrol officers responding to the Wal-Mart for misdemeanor shoplifting calls. A surprise to those involved in the program was the significant reduction in shoplifting (21%) when compared to the same time frame during the previous year. The original belief was that shoplifting arrests would increase significantly because of the additional time for loss prevention officers to be able to

detect shoplifters. One loss prevention officer commented that the store had to lower the number of arrests loss prevention officers are required to make because of T.R. A.P. The increased police presence and the signs warning of the cooperative effort between the Police Department and Walmart were having the intended impact.

Program Expansion

Since the completion of the pilot program in August of 1999, the program has been taken citywide. Grocery stores, Wal-Mart, Target, Sears and many others have joined forces with T.R. A.P. At loss prevention meetings attended by Officer Simmonds, she has been requested to assist in expanding T.R.A.P. in various locations in the Phoenix metropolitan area. Out of state inquiries have also come in requesting information on the program.

Future Implications for T.R.A.P.

The 2236 shoplifting cases Mesa police officers handled in 1999, resulted in an expenditure of 6708 man hours by the department (number of cases multiplied by a three hour average spent on each case). Based on the pilot project T.R.A.P. should be able to reduce the 2236 shoplifting cases officers responded to in 1999 by half. This would result in the savings of 3354 police man-hours.

At the present time the retail businesses are only using T.R.A.P. for cases of shoplifting with losses of one hundred dollars or less. As they become more confident in the program the department would like to up the loss amount to the statutory limit of \$250.00 for misdemeanor crimes. Such a change would bring almost all such thefts under T.R.A.P.

Agency Information

Level of Involvement

One officer (Helen Simmonds) was assigned from the Central Community Action Team to be the T.R.A.P. Coordinator. She has literally become the business community police officer. Officer Simmonds has involved other community action officers in her projects and has gained assistance from other divisions in the department, such as the Criminal Investigation Unit and the Gang Enforcement Unit.

Training

Officer Simmonds attended briefings to educate officers on the fundamentals of the Theft Reduction Action Program. Store employees were educated in the area of crime prevention at their stores and loss prevention officers were trained how to write reports containing the proper elements of a crime.

Resources

Community Action Team officers in each patrol district are encouraged to work with T.R.A.P.

Program Obstacles

Some obstacles were overcome early on during the implementation stage of the program. Concerns expressed by supervisors during the original proposal presentation to Mesa Police Department Staff included: legalities of giving out warrant information to civilians, and loss of intelligence information because officers would no longer be interviewing shoplifting suspects.

The Department's Legal Unit checked on the legalities of providing information to loss prevention officers about the wanted status of an in custody shoplifter. The determination was that the information could be provided. In the matter of loss intelligence information we have found the contrary to be true. Officer Simmonds has gathered a plethora of intelligence information as a T.R.A.P. Officer.

Synopsis

The Theft Reduction Action Program has accomplished the established goals - crime reduction, enhanced relationships between the business community and Mesa Police

Department. T.R.A.P. has allowed the Mesa Police Department to boast a community policing initiative in every aspect of our community (neighborhoods, schools, churches, and now the business community).

Project Contact Persons

Officer Helen Simmonds
Mesa Police Department
130 N. Robson
Mesa, AZ. 85201
Phone: 480-644-4061

Sergeant Jim Schweisthal
130 N. Robson
Mesa, AZ. 85201
Phone: 644-2211

Lieutenant John Pruitt
130 N. Robson
Mesa, AZ.
Phone: 644-5279

Graphs of Selected Shoplift Data

1999 1st Quarter Shoplift Calls by District

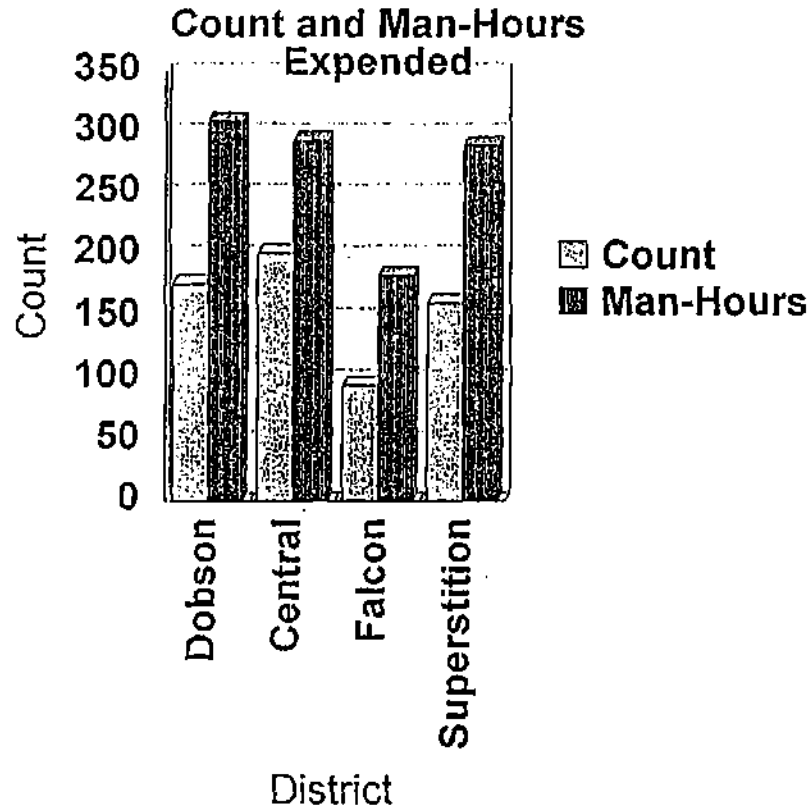

Walmart Shoplift Calls for March 1999 (1305 W Main store only)

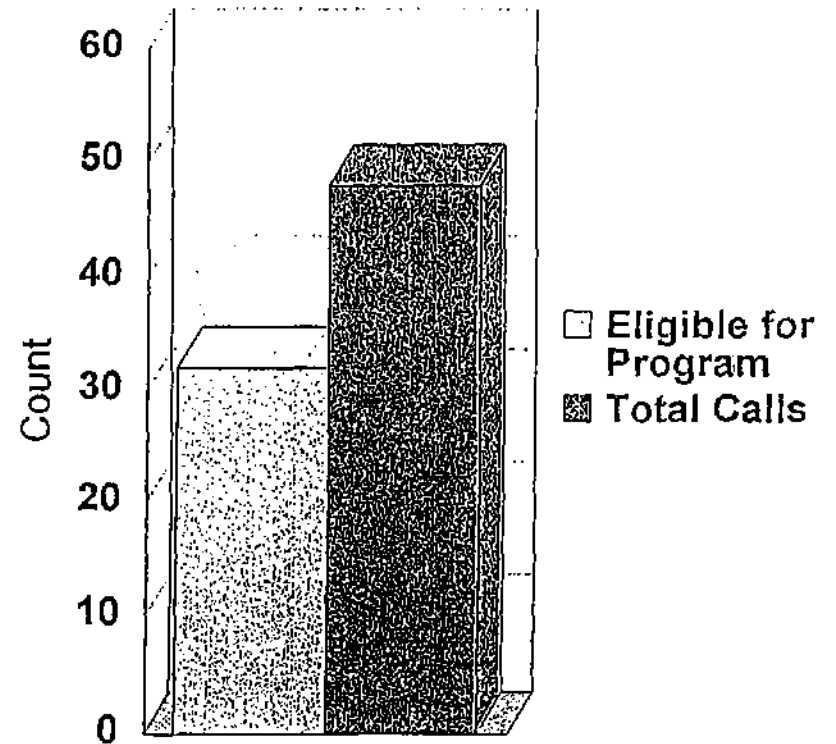

APPENDIX 2

END OF TRAP PILOT REPORT

CITY OF MESA POLICE DEPARTMENT MEMO

To: CHIEF and POLICE DEPARTMENT STAFF
Through: COMMANDER GIL OTANEZ
From: LIEUTENANT JOHN PRUITT, SERGEANT JIM SCHWEISTHAL and
OFFICER HELEN SIMMONDS
Date: AUGUST 12, 1999
RE: END OF TRAP PILOT REPORT

Recommendation

The Community Action Team recommends TRAP be expanded in two phases throughout the City of **Mesa**. The first phase would last three months and would expand the program throughout the Central District. The second phase would **expand** the program into the other three Patrol Districts.

History

The Theft Reduction Action Program (TRAP) began a three-month pilot phase on May 17, 1999. The pilot program was conducted at the Wal-Mart at 1305 W. Main Street, Mesa AZ. The goals of the pilot program were to reduce the incident of misdemeanor crimes at the store, reduce the number of calls for service to the Central Patrol District officers and to establish a working relationship between the retail **merchant**, the City Prosecutor's Office and the Police Department. At the end of the three months the pilot program has been a success.

Discussion

It was anticipated that there would be an immediate decrease in the number of calls for service that required a patrol response because of the Summons in Lieu of Citation part of the program. As indicated in the chart 1, this did in fact happen. It was, also, anticipated that there would be an immediate increase in the total number of shoplifters apprehended due to the increase in time available to the **loss** prevention agents of the store. This did not occur because **our** expectation that the other features of TRAP, such as the signs and increased awareness, would take a protracted time period to be effective was erroneous. Unexpectedly, the crime prevention aspects of TRAP yielded immediate benefits and reduced the actual occurrence of shoplifting.

During the pilot program (May, June and July) there was a 21% reduction in the incidents of shoplifting and a 55% reduction in Patrol Officer responses. The working relationship between the store, the City Prosecutor's Office and this Department was established. And it is in place, ready for expansion. Therefore, the goals of the pilot program were met and our expectations were exceeded. Based on this the Central CAT considers the pilot a great success and recommends the program's expansion.

Month	Shoplifting Calls		% Change	Patrol Responses		% Change
	1998	1999		'98	'99	
May	26	18		26	13	
June	26	23		26	14	
July	17	13		17	11	
Totals	69	54	21%	69	38	55%

Chart 1.

Note: During the pilot program there were 16 cases referred to SILOC.

APENDIX 3

1999 YEARLY CALLS FOR SERVICE REPORT

CITY OF MESA, ARIZONA
POLICE DEPARTMENT
CALLS FOR SERVICE

YEARLY REPORT
1999

CRIME ANALYSIS UNIT
MESA POLICE DEPARTMENT

Part of the responsibility of the Crime Analysis Unit of the Mesa Police Department is to provide timely and pertinent information **both** to the City and the public in regards to crime frequencies and patterns. In an effort to further this responsibility, the unit is providing general information regarding the work load of the patrol division of the Mesa Police **Department**. This information **is** attached with this memo and consists of Beat Statistics for the Year 1999 for the City of Mesa.

These statistics are contained in four reports, one for each geographical district within the City. These districts currently consist of the Dobson District, the Central District, Falcon **District** and the **Superstition District**. The boundaries of these districts are shown on the attached city map. Each district is further divided into a series of areas with the City called "**beats**". Each district report includes a map of the district showing the current beat boundaries. Note: As of June **1999**, these beats were changed from the previous ones. The new beats are reflected in the maps.

The information contained in the report is based on calls for service received by the department where an officer or officer(s) are **actually** dispatched. It is broken down into several areas of concern: 1. Disposition Codes (DC codes) - These are codes given to each call by the assigned officer at the conclusion of the call. 2. Average response times based on the priority of the **call**. Each call for service is given a priority rating depending on the information received as to the urgency of the call. Emergency calls are given an "E" status. The reported figure is the average time from receiving the call to the time that officers arrive at the scene. 3. The actual count of the various types of calls within the beats. Each **call** type is classified and the count for each type is reported for the individual beat.

These totals **will** be updated each **quarter** and are distributed to all districts. In addition, they will be made available to the public through the TeJeserve desk (Front Desk) at the main police station and the **Mesa** Public Library. There is also beat information that may be accessed on the internet at

http://www.ci.mesa.az.us/police/crime_analysis_unit.htm

This internet information is being expanded on a constant basis so check frequently.

We hope that you will find this information **helpful** to you.

HOW TO USE THESE CHARTS

1. Determine the area of the City that you are interested in checking the statistics in and then locate this area on the map of the City. Determine which district it is in - i.e. **Dobson, Central, Falcon, or Superstition.**
2. Look at the **District Map** for the district in question and determine which **Beat Number** that the concerned area falls into.
3. Locate that **Beat Number** in the reported totals and review the statistics.

Notes:

Beat 81 of the Falcon District encompasses the area of Williams Gateway Airport and is not included in the **district** totals or averages.

This information is extracted from raw CAD data. The accuracy of the information is based on proper CAD operation and data entry. Chances for error are possible.

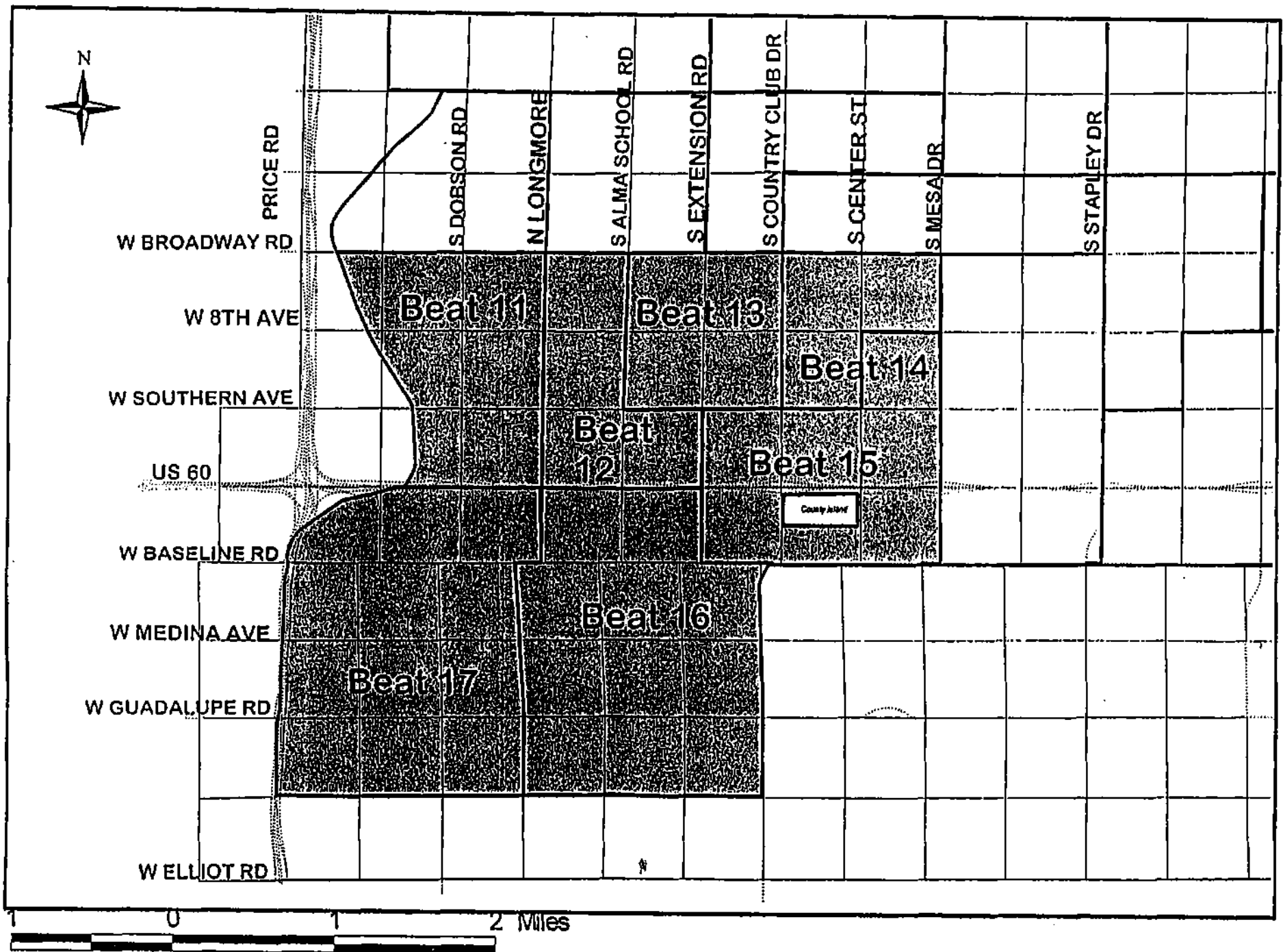

DOBSON DISTRICT - BEATS 11 to 17

DOBSON CAD/RECORDS BEAT STATISTICS
Yearly Report - 1999

	Overall Dobson Statistics
DC1 - DR WRITTEN	15,189
DC2 - GOA	5,976
DC3 - UNFOUNDED	473
DC4 - MESSAGE	1,098
DC5 - CIVIL	22,430
DC6 - FALSE ALARM	3,680
DC7 - TRAFFIC/CROWD	246
DC8 - FI CARD	0
DC9 - TURNED OVER	1,763
DC10 - THEFT < \$50	75
DC11 - NO DISPATCH	24
DC12	0
DCS - SUPPLEMENT	1,943
CANC. - CANCELLED	612
OTHER	21,608
E - INITIATE/ON SCENE	3.8
1 - INITIATE/ON SCENE	6.9
2 - INITIATE/ON SCENE	26.0
3 - INITIATE/ON SCENE	32.6
4 - INITIATE/ON SCENE	54.2
5 - INITIATE/ON SCENE	92.6

NOTE: The first page consists of overall District statistics concerning disposition of calls and average response times to differing call types. The remaining report shows call type counts for the beats.

	BEAT 11	BEAT 12	BEAT 13	BEAT 14	BEAT 15	BEAT 16	BEAT 17	TOTAL	AVG
UNCODED INCIDENT	221	128	196	145	109	107	155	1061	152
WARRANT ARREST	218	147	112	139	223	184	573	1596	228
EMERGENCY MESSAGE	11	6	1	5	9	5	3	40	6
MOTORIST ASSISTANCE	14	15	11	5	52	9	51	157	22
ARMED ROBBERY	9	8	10	6	9	6	17	65	9
ARMED ROBB ALARM	32	44	18	15	26	37	33	205	29
ARMED ROBB PROG	0	0	0	0	0	0	0	0	0
STRONG ARMED ROBB	13	5	4	4	3	1	2	32	5
DRUGS	127	69	104	97	104	48	54	603	86
TRESPASS	139	67	165	93	96	44	52	656	94
FIGHT	79	47	69	62	48	30	44	379	54
ASSAULT	156	53	48	37	65	28	43	430	61
AGGRAVATED ASSAULT	8	14	6	3	14	10	6	61	9
SEXUAL ASSAULT	14	3	4	3	8	2	14	48	7
PROSTITUTION	3	0	2	1	3	1	0	10	1
MOLESTING	10	6	9	4	7	6	8	50	7
INDECENT EXPOSURE	17	23	15	7	13	4	11	90	13
FORGERY	20	31	6	6	54	22	37	176	25
BAD CHECK	0	2	1	0	3	1	0	7	1
CREDIT CARD FRAUD	32	35	13	4	31	21	31	167	24
DEFRAUD INKEEPER	0	0	0	0	1	0	0	1	0
FRAUD INVESTIGATION	4	1	3	0	4	6	7	25	4
FOUND PROPERTY	50	37	40	36	40	45	79	327	47
DRUNK	14	7	11	10	10	3	8	63	9
OBSCENE/HARASS CALLS	13	9	12	5	6	18	12	75	11
HARASSMENT	29	26	15	12	19	21	18	140	20
THREATS	89	64	50	35	50	44	52	384	55
NEIGHBOR TROUBLE	55	44	53	43	33	37	30	285	42
CRIMINAL DAMAGE	186	128	112	68	125	167	178	964	138
JUVENILES DISTURBING	165	105	93	137	128	179	248	1055	151
SUBJECT DISTURBING	784	447	425	342	514	322	376	3210	459

Dobson District - Yearly Report 1999

	BEAT 11	BEAT 12	BEAT 13	BEAT 14	BEAT 15	BEAT 16	BEAT 17	TOTAL	AVG
ACCIDENT W/O INJURY	330	243	204	235	725	434	530	2,701	386
H&R ACCIDENT W/O INJ..	99	72	59	50	121	63	91	555	79
ACCIDENT WITH INJURY	108	90	78	69	207	132	150	804	119
H&R ACCIDENT W/INJ.	6	1	3	0	1	0	5	16	2
FATAL ACCIDENT	0	0	0	0	0	0	0	0	0
OFFICER INV SHOOTING	0	0	0	0	0	0	0	0	0
OFCCR URGENT HELP	0	0	1	0	0	0	0	1	0
SELECT BEAT TOTALS	9,956	7,110	6,904	5,716	9,189	7,320	9,233	55,428	7,918
PERCENT OF CALLS	18.0%	12.8%	12.5%	10.3%	16.6%	13.2%	16.7%	100%	

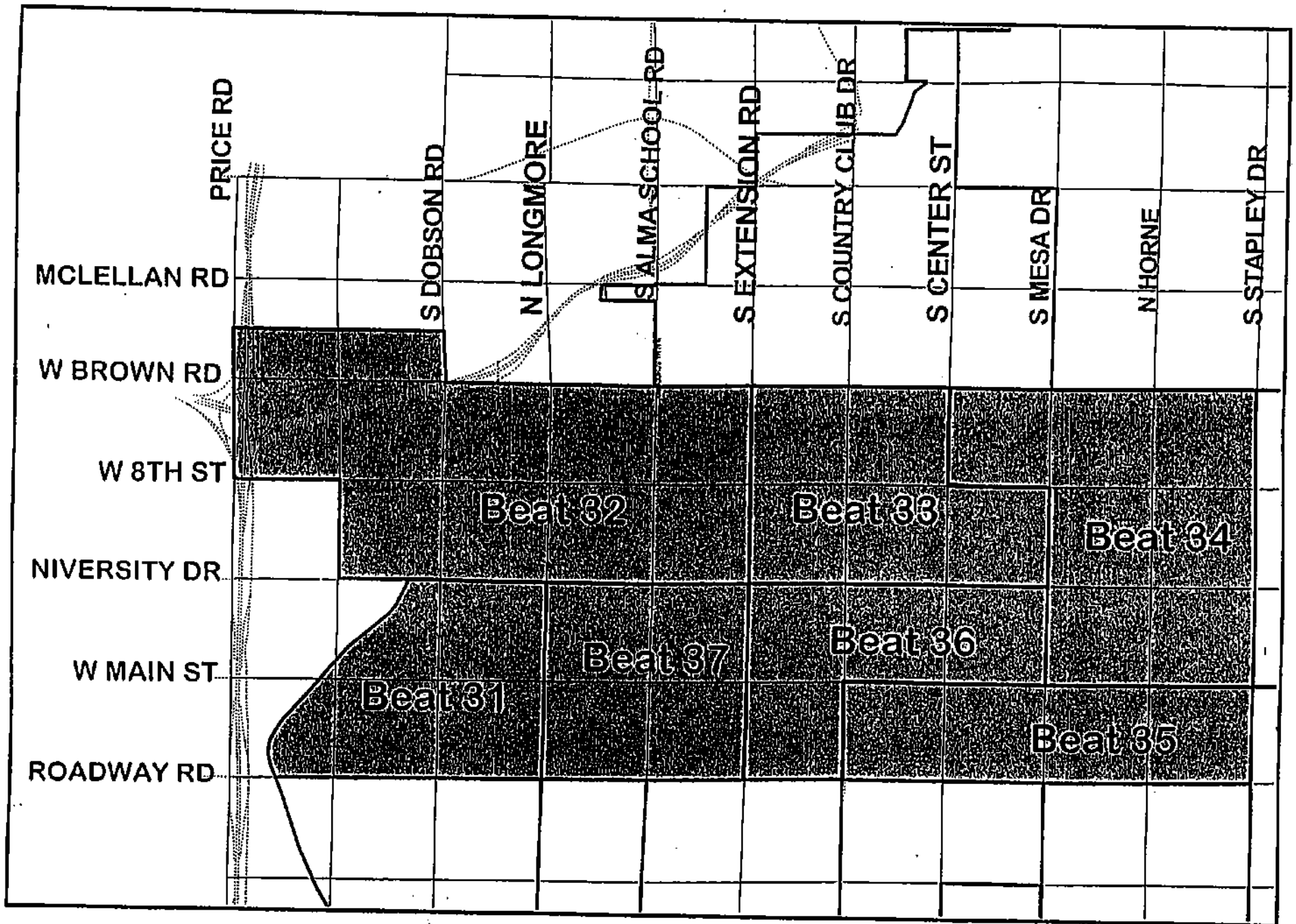

CENTRAL DISTRICT - BEATS 31 to 37

	BEAT 11	BEAT 12	BEAT 13	BEAT 14	BEAT 15	BEAT 16	BEAT 17	TOTAL	AVG
SUSPICIOUS ACTIVITY	344	210	212	215	277	276	329	1863	266
SUSPICIOUS PERSON	157	97	134	105	128	105	128	854	122
SUSPICIOUS VEHICLE	158	71	113	91	133	105	155	826	118
SUICIDE	43	22	21	15	29	25	36	191	27
DWI	117	81	123	108	113	53	97	692	99
BOMB THREAT	2	6	1	0	2	4	10	25	4
PICKUP DOG	71	55	63	77	58	76	74	474	68
DOG BITE	15	12	9	15	11	22	19	103	15
DEAD DOG	17	9	10	33	17	16	25	127	18
PICKUP CAT	57	32	38	56	32	69	50	334	48
CAT BITE	4	1	2	0	1	7	5	20	3
DEAD CAT	28	21	24	35	32	33	29	202	29
DOGS AT LARGE	60	42	89	142	51	91	138	613	88
BARKING DOG	66	38	83	23	30	123	145	508	73
MISC ANIMAL REPORT	38	48	29	33	33	33	65	279	40
MISC ANIMAL BITE	2	0	1	0	0	0	0	3	0
WELFARE CHECK	485	276	283	203	355	274	263	2139	306
SHOOTING	6	0	1	3	2	1	3	16	2
CUTTING/STABBING	4	1	0	1	1	0	0	7	1
DEAD BODY	40	4	2	9	3	3	9	70	10
FIRE FOLLOW UP ARSON	1	1	0	0	0	0	2	4	1
OFFICER ASSIST/MINOR	3	1	2	5	5	0	2	18	3
OFFICER SENT FOLLOW UP	262	121	157	117	179	236	215	1287	184
SOLICITOR CHECK	5	0	5	0	6	4	8	28	4
OTHER AGENCY ASSIST	380	205	198	170	353	234	345	1885	269
URGENT HELP P.D.	1	0	0	0	0	0	0	1	0
CITY CODE VIOLATION	141	76	204	111	82	112	178	904	129
ABANDONED VEHICLE	32	32	29	101	42	62	87	385	55
INSANE PERSON	27	12	5	12	8	11	5	80	11
PROWLER	22	12	18	15	15	16	31	129	18
UNKNOWN TROUBLE	1011	649	594	441	868	525	612	4700	671
PANIC ALARM/UNK	22	28	13	15	41	52	50	221	32

Dobson District - Yearly Report 1999

	BEAT 11	BEAT 12	BEAT 13	BEAT 14	BEAT 15	BEAT 16	BEAT 17	TOTAL	AVG
NOISE DISTURB	470	365	286	300	228	290	329	2,268	324
FAMILY FIGHT	158	113	106	90	108	78	87	740	106
SHOTS FIRED	82	57	42	83	46	38	51	399	57
SUBJECT WITH GUN	16	18	10	15	11	11	11	92	13
SUBJECT WITH KNIFE	6	1	1	1	3	4	1	17	2
CIVIL MATTER	397	272	302	259	360	258	322	2,170	310
CUSTODIAL/ACCESS INTER	21	9	9	14	19	23	12	107	15
DRIVE BY SHOOTING	0	0	0	0	0	0	0	0	0
GRAFFITI	0	0	2	0	0	0	0	2	0
PARTYCREW	0	0	0	0	0	0	0	0	0
HOMICIDE	0	0	0	0	0	0	0	0	0
BURGLARY ALARM	526	499	487	305	861	741	858	4,277	611
BURGLARY COMMERCIAL	30	26	32	24	66	40	33	251	36
BURGLARY RESIDENTIAL	91	56	73	59	74	85	96	594	76
BURGLARY VEHICLE	305	201	199	73	263	261	187	1,489	213
THEFT COMMERCIAL	218	189	161	52	199	118	178	1,115	159
THEFT RESIDENTIAL	130	83	55	48	97	88	107	608	87
THEFT FROM VEHICLE	70	33	32	17	50	57	43	302	43
SHOPLIFTER	19	430	50	0	73	14	85	671	96
KIDNAPPING	2	0	0	0	0	0	2	4	1
TRAFFIC CONTROL	10	21	23	6	88	31	44	223	32
AUTO THEFT	135	138	117	85	121	138	145	879	126
AUTO THEFT RECOVERY	50	33	32	45	41	34	27	262	37
SPEEDING VEHICLE	1	2	3	10	6	1	6	29	4
SUSP OR REVOKED LICENSE	254	224	222	205	211	113	160	1,389	198
TRAFFIC HAZARD	89	90	133	105	381	173	214	1,185	169
ILLEGAL PARKING	15	13	9	10	6	8	30	91	13
INFO RECEIVED	17	14	13	3	15	8	29	99	14
MISSING PERSON	133	80	76	65	85	98	132	669	96
CHILD NEGLECT	35	3	13	13	9	5	11	89	13

Central District - Yearly Report 1999

	BEAT 31	BEAT 32	BEAT33	BEAT 34	BEAT 35	BEAT 36	BEAT 37	TOTAL	AVG
NOISE DISTURB	378	243	196	245	146	176	179	1563	223
FAMILY FIGHT	130	113	118	112	64	77	103	717	102
SHOTS FIRED	67	68	62	78	48	39	35	397	57
SUBJECT WITH GUN	13	14	14	12	14	12	12	91	13
SUBJECT WITH KNIFE	3	4	6	5	6	2	12	38	5
CIVIL MATTER	274	222	287	286	201	380	279	1929	276
CUSTODIAL/ACCESS INTER	7	11	10	9	8	28	7	80	11
DRIVE BY SHOOTING	0	0	0	0	0	0	0	0	0
GRAFFITI	0	0	0	0	0	0	0	0	0
PARTYCREW	0	0	0	0	0	0	0	0	0
HOMICIDE	0	0	0	0	0	0	0	0	0
BURGLARY ALARM	533	371	419	434	314	632	505	3208	458
BURGLARY COMMERCIAL	36	37	31	29	49	54	53	289	41
BURGLARY RESIDENTIAL	87	125	128	179	94	90	60	763	109
BURGLARY VEHICLE	166	149	152	137	114	129	140	987	141
THEFT COMMERCIAL	150	110	105	113	125	182	191	976	139
THEFT RESIDENTIAL	75	99	88	132	83	135	91	703	100
THEFT FROM VEHICLE	40	27	32	29	27	41	32	228	33
SHOPLIFTER	169	14	76	6	14	2	325	606	87
KIDNAPPING	0	0	0	2	0	3	4	9	1
TRAFFIC CONTROL	25	20	15	10	19	31	19	139	20
AUTO THEFT	111	80	73	90	110	123	107	694	99
AUTO THEFT RECOVERY	53	39	38	35	46	30	46	287	41
SPEEDING VEHICLE	3	4	2	4	7	10	6	36	5
SUSP OR REVOKED LICENSE	283	195	228	237	272	266	274	1755	251
TRAFFIC HAZARD	136	95	136	159	124	163	123	936	134
ILLEGAL PARKING	20	10	7	11	9	17	12	86	12
INFO RECEIVED	14	8	9	14	9	44	11	109	16
MISSING PERSON	202	155	99	254	61	138	73	982	140
CHILD NEGLECT	9	30	17	18	8	35	8	125	18

	BEAT 31	BEAT 32	BEAT33	BEAT 34	BEAT 35	BEAT 36	BEAT 37	TOTAL	AVG
SUSPICIOUS ACTIVITY	295	255	268	346	257	225	275	1792	274
SUSPICIOUS PERSON	135	111	141	193	142	130	126	978	140
SUSPICIOUS VEHICLE	127	113	80	159	77	97	103	756	108
SUICIDE	29	27	32	40	25	27	35	215	31
DWI	115	84	73	82	164	179	127	824	118
BOMB THREAT	2	0	1	0	4	2	5	14	2
PICKUP DOG	49	81	93	90	52	32	42	439	63
DOG BITE	18	17	16	26	7	20	7	110	16
DEAD DOG	16	29	28	33	14	19	15	154	22
PICKUP CAT	40	44	66	86	45	82	35	398	57
CAT BITE	3	14	20	7	1	2	2	49	7
DEAD CAT	33	40	48	47	28	36	36	268	38
DOGS AT LARGE	72	118	102	110	75	92	84	653	93
BARKING DOG	59	39	30	71	9	63	58	329	47
MISC ANIMAL REPORT	45	41	30	56	23	45	27	267	38
MISC ANIMAL BITE	1	0	1	0	0	0	0	2	0
WELFARE CHECK	352	303	422	346	286	348	353	2410	344
SHOOTING	1	4	5	5	0	4	1	20	3
CUTTING/STABBING	1	3	3	5	0	1	0	13	2
DEAD BODY	8	12	25	9	5	13	3	75	11
FIRE FOLLOW UP ARSON	0	0	0	0	0	1	0	1	0
OFFICER ASSIST/MINOR	1	0	0	0	1	3	1	6	1
OFFICER SENT FOLLOW UP	159	148	138	166	115	243	130	1099	157
SOLICITOR CHECK	1	0	2	6	2	1	1	13	2
OTHER AGENCY ASSIST	253	211	298	270	223	921	211	2387	341
URGENT HELP P.D.	0	0	0	0	0	0	0	0	0
CITY CODE VIOLATION	82	83	78	122	73	84	74	596	85
ABANDONED VEHICLE	32	56	50	80	50	82	44	394	56
INSANE PERSON	4	4	15	6	13	13	10	65	9
PROWLER	20	19	9	23	14	19	14	118	17
UNKNOWN TROUBLE	584	553	703	619	590	619	581	4249	607
PANIC ALARM/UNK	32	28	31	41	30	27	22	211	30

CENTRAL CAD/RECORDS BEAT STATISTICS
Yearly Report 1999

	Overall Central District Statistics
DC1 - DR WRITTEN	20,763
DC2 - GOA	5,829
DC3 - UNFOUNDED	450
DC4 - MESSAGE	389
DC5 - CIVIL	21,932
DC6 - FALSE ALARM	2,841
DC7 - TRAFFIC/CROWD	124
DC8 - FI CARD	0
DC9 - TURNED OVER	1,886
DC10 - THEFT < \$50	323
DC11 - NO DISPATCH	16
DC12	0
DCS - SUPPLEMENT	1,755
CANC. - CANCELLED	730
OTHER	23,888
E - INITIATE/ON SCENE	3.5
1 - INITIATE/ON SCENE	6.4
2 - INITIATE/ON SCENE	26.7
3 - INITIATE/ON SCENE	34.8
4 - INITIATE/ON SCENE	63.3
5 - INITIATE/ON SCENE	95.4

NOTE: The first page consists of overall District statistics concerning disposition of calls and average response times to differing call types. The remaining report shows call type counts for the beats.

	BEAT 31	BEAT 32	BEAT 33	BEAT 34	BEAT 35	BEAT 36	BEAT 37	TOTAL	AVG
UNCODED INCIDENT	202	152	177	208	205	486	169	1,599	228
WARRANT ARREST	190	128	157	166	153	692	193	1,679	240
EMERGENCY MESSAGE	4	4	5	6	3	1	6	29	4
MOTORIST ASSISTANCE	26	15	14	12	7	17	15	106	15
ARMED ROBBERY	20	2	5	8	11	14	12	72	10
ARMED ROBB ALARM	12	18	34	12	40	20	28	164	23
ARMED ROBB PROG	0	0	0	0	0	0	0	0	0
STRONG ARMED ROBB	5	6	7	7	9	13	1	48	7
DRUGS	116	103	125	219	138	279	127	1,107	158
TRESPASS	107	89	128	102	278	152	174	1,030	147
FIGHT	68	47	65	52	60	46	59	397	57
ASSAULT	71	80	72	76	41	125	66	531	76
AGGRAVATED ASSAULT	9	10	15	20	6	20	13	93	13
SEXUAL ASSAULT	8	4	7	1	4	30	8	62	9
PROSTITUTION	44	1	1	2	6	30	34	118	17
MOLESTING	6	9	8	18	7	41	8	97	14
INDECENT EXPOSURE	8	12	15	15	20	14	8	92	13
FORGERY	53	9	19	11	19	46	30	187	27
BAD CHECK	3	0	2	0	0	2	5	12	2
CREDIT CARD FRAUD	22	10	19	25	20	72	25	193	28
DEFRAUD INKEEPER	0	1	0	0	0	1	0	2	0
FRAUD INVESTIGATION	6	4	0	2	4	3	1	20	3
FOUND PROPERTY	50	62	46	57	47	130	46	438	63
DRUNK	8	9	10	13	14	29	10	93	13
OBSCENE/HARASS CALLS	12	6	12	6	7	15	8	66	9
HARASSMENT	28	27	23	29	15	29	16	167	24
THREATS	55	69	64	66	42	82	43	421	60
NEIGHBOR TROUBLE	39	55	47	43	23	30	42	279	40
CRIMINAL DAMAGE	144	144	121	120	98	126	120	873	125
JUVENILE DISTURB	163	207	148	218	103	90	154	1,083	155
SUBJECT DISTURB	541	454	495	512	399	420	520	3,341	477

	BEAT 31	BEAT 32	BEAT 33	BEAT 34	BEAT 35	BEAT 36	BEAT 37	TOTALS	AVG
ACCIDENT W/O INJURY	230	189	254	254	246	284	225	17682	240
H&R ACCIDENT W/O INJ..	90	58	60	76	46	67	66	463	66
ACCIDENT WITH INJURY	100	78	95	111	98	87	86	655	94
H&R ACCIDENT W/INJ.	3	4	3	3	2	8	2	25	4
FATAL ACCIDENT	1	0	0	0	0	0	0	1	0
OFFICER INV SHOOTING	0	0	0	0	1	0	0	1	0
OFFICER URGENT HELP	0	0	0	0	0	1	0	1	0
SELECT BEAT TOTALS	7,997	6,748	7,709	8,164	6,469	9,771	7,449	59,995	7,714
PERCENT OF CALLS	14.8%	12.5%	13.7%	15.1%	12.0%	18.1%	13.8%	100%	

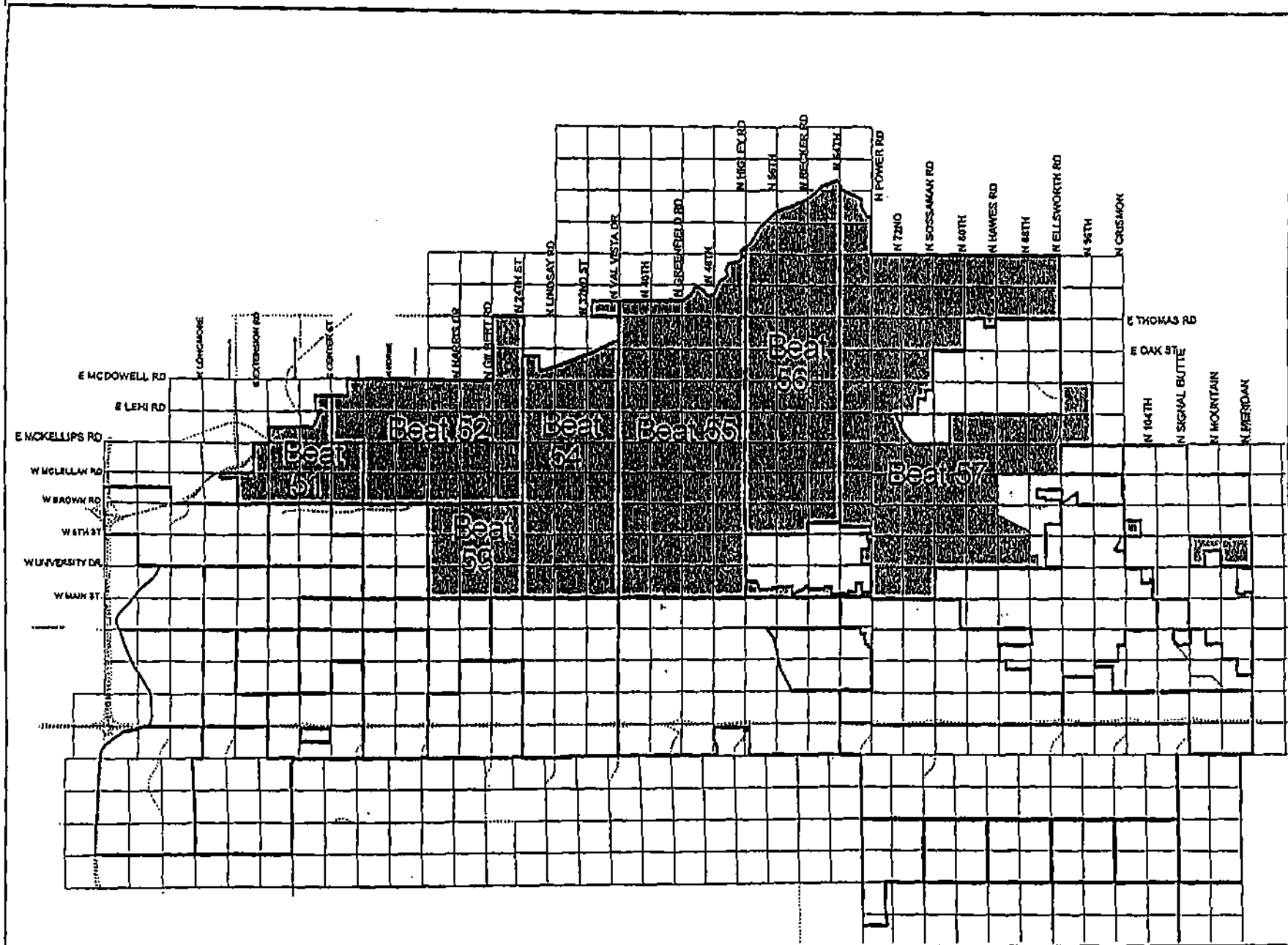

FALCON DISTRICT BEATS 51 to 57

FALCON CAD/RECORDS BEAT STATISTICS
Yearly Report - 1999

	Overall Falcon District Statistics
DC1 - DR WRITTEN	14,825
DC2 - GOA	6,015
DC3 - UNFOUNDED	581
DC4 - MESSAGE	728
DC5 - CIVIL	25,557
DC6 - FALSE ALARM	4,442
DC7 - TRAFFIC/CROWD	219
DC8 - FI CARD	0
DC9 - TURNED OVER	1,791
DC10 - THEFT < \$50	95
DC11 - NO DISPATCH	29
DC12	0
DCS - SUPPLEMENT	1,837
CANC. - CANCELLED	708
OTHER	22,401
E - INITIATE/ON SCENE	4.4
1 - INITIATE/ON SCENE	7.9
2 - INITIATE/ON SCENE	27.2
3 - INITIATE/ON SCENE	35.2
4 - INITIATE/ON SCENE	66.6
5 - INITIATE/ON SCENE	104.4

NOTE: The first page consists of overall District statistics concerning disposition of calls and average response times to differing call types. The remaining report shows call type counts for the beats.

Falcon District - Yearly Report 1999

	BEAT 51	BEAT 52	BEAT 53	BEAT 54	BEAT 55	BEAT 56	BEAT 57	TOTAL	AVG
UNCODED INCIDENT	189	148	219	203	234	182	68	1243	178
WARRANT ARREST	258	121	155	135	274	98	56	1097	157
EMERGENCY MESSAGE	8	9	6	11	5	8	10	57	8
MOTORIST ASSISTANCE	11	22	13	20	22	25	0	113	16
ARMED ROBBERY	5	4	12	6	13	4	0	44	6
ARMED ROBB ALARM	9	27	9	25	21	31	14	136	19
ARMED ROBB PROG	0	0	0	0	17	0	1	18	3
STRONG ARMED ROBB	6	3	4	5	2	5	31	56	8
DRUGS	92	65	112	83	52	71	21	496	71
TRESPASS	75	69	104	68	49	84	23	472	67
FIGHT	40	31	45	48	43	42	28	277	40
ASSAULT	68	72	73	55	58	53	14	393	56
AWDW	13	13	12	10	11	8	5	72	10
SEXUAL ASSAULT	6	2	12	10	13	7	0	50	7
PROSTITUTION	1	0	3	2	0	0	0	6	1
MOLESTING	12	12	11	18	19	4	1	77	11
INDECENT EXPOSURE	11	12	9	17	8	8	6	71	10
FORGERY	6	24	23	12	35	21	11	132	19
BAD CHECK	0	2	2	1	1	0	0	6	1
CREDIT CARD FRAUD	9	22	18	24	29	20	11	133	19
DEFRAUD INKEEPER	0	0	1	1	0	1	0	3	0
FRAUD INVESTIGATION	1	1	2	4	5	4	0	17	2
FOUND PROPERTY	41	75	66	67	112	54	40	455	65
DRUNK	5	5	16	6	10	8	0	50	7
OBSCENE/HARASS CALLS	13	15	12	22	10	11	8	91	13
HARASSMENT	25	37	19	43	26	37	14	201	29
THREATS	59	53	73	53	83	62	27	410	59
NEIGHBOR TROUBLE	110	99	53	86	58	65	17	488	70
CRIMINAL DAMAGE	175	197	213	236	244	317	183	1565	224
JUVENILE DISTURB	307	415	259	386	333	419	168	2287	327
SUBJECT DISTURB	583	498	621	476	394	336	173	5368	440

Ialcon District - Yearly Report 1999

	BEAT 51	BEAT 52	BEAT 53	BEAT 54	BEAT 55	BEAT 56	BEAT 57	TOTAL	AVG
NOISE DISTURB	315	289	295	328	178	175	75	1,655	236
FAMILY FIGHT	154	151	133	141	127	126	45	877	125
SHOTS FIRED	70	104	64	70	47	60	32	497	64
SUBJECT WITH GUN	12	7	14	6	11	14	8	72	10
SUBJECT WITH KNIFE	2	2	2	2	3	4	1	16	2
CIVIL MATTER	412	419	382	427	409	368	170	2,587	370
CUSTODIAL/ACCESS INTER	20	28	22	41	25	19	9	164	23
DRIVE BY SHOOTING	0	0	0	0	0	0	0	0	0
GRAFFITI	0	1	0	0	1	0	0	2	0
PARTYCREW	0	0	0	0	0	0	0	0	0
HOMICIDE	0	0	0	1	0	0	0	1	0
BURGLARY ALARM	488	1014	616	957	1028	906	759	5,768	824
BURGLARY COMMERCIAL	36	32	56	58	47	45	41	315	45
BURGLARY RESIDENTIAL	139	148	194	191	139	111	79	1,001	143
BURGLARY VEHICLE	226	176	242	203	147	165	170	1,329	190
THEFT COMMERCIAL	124	122	171	154	193	200	108	1,072	153
THEFT RESIDENTIAL	111	179	149	148	132	106	62	887	127
THEFT FROM VEHICLE	49	33	44	40	43	48	29	286	41
SHOPLIFTER	8	52	146	44	63	36	2	351	50
KIDNAPPING	0	0	0	0	0	0	0	0	0
TRAFFIC CONTROL	12	29	18	30	28	36	14	167	24
AUTO THEFT	122	121	122	86	88	91	54	684	98
AUTO THEFT RECOVERY	39	46	35	35	25	50	31	261	37
SPEEDING VEHICLE	5	13	10	18	11	27	0	84	12
SUSP OR REVOKED LICENSE	258	223	291	203	192	148	87	1,402	200
TRAFFIC HAZARD	142	182	122	217	181	163	111	1,118	160
ILLEGAL PARKING	19	18	19	23	14	26	0	119	17
INFO RECEIVED	9	11	6	20	21	10	6	83	12
MISSING PERSON	147	163	141	140	155	174	80	1,000	143
CHILD NEGLECT	17	10	19	14	14	21	9	104	15

Falcon District - Yearly Report 1999

	BEAT 51	BEAT 52	BEAT 53	BEAT 54	BEAT 55	BEAT 56	BEAT 57	TOTAL	AVG
SUSPICIOUS ACTIVITY	347	421	383	381	369	360	172	2,433	348
SUSPICIOUS PERSON	134	147	170	141	129	106	64	891	127
SUSPICIOUS VEHICLE	142	228	157	200	199	168	105	1,199	171
SUICIDE	30	30	38	26	36	23	7	190	27
DWI	77	67	111	99	109	102	98	663	95
BOMB THREAT	3	3	4	3	2	1	1	17	2
PICKUP DOG	112	140	113	95	103	105	80	748	107
DOG BITE	26	30	23	29	28	21	15	172	25
DEAD DOG	30	37	34	47	38	34	30	250	36
PICKUP CAT	103	180	79	136	61	35	23	617	88
CAT BITE	7	7	5	3	8	6	5	41	6
DEAD CAT	46	70	47	47	53	45	17	325	46
DOGS AT LARGE	184	232	157	145	167	116	97	1,098	157
BARKING DOG	94	164	103	162	150	207	87	967	138
MISC ANIMAL REPORT	76	109	60	88	77	102	39	550	79
MISC ANIMAL BITE	0	1	0	0	1	0	0	2	0
WELFARE CHECK	346	370	381	332	404	311	160	2,304	329
SHOOTING	1	0	0	2	5	0	2	10	1
CUTTING/STABBING	0	2	0	2	0	1	0	5	1
DEAD BODY	8	14	6	14	16	18	11	87	12
FIRE FOLLOW UP ARSON	1	0	0	0	0	1	0	2	0
OFFICER ASSIST/MINOR	1	1	1	0	10	0	2	15	2
OFFICER SENT FOLLOW UP	230	221	248	241	208	192	129	1,469	210
SOLICITOR CHECK	1	2	3	2	2	7	0	17	2
OTHER AGENCY ASSIST	280	290	289	258	407	280	162	1,966	281
URGENT HELP P.D.	0	0	0	0	0	0	0	0	0
CITY CODE VIOLATION	109	162	99	238	151	197	113	1,069	153
ABANDONED VEHICLE	52	105	68	85	74	80	64	528	75
INSANE PERSON	4	8	7	3	6	8	2	38	5
PROWLER	25	39	23	23	24	37	29	200	29
UNKNOWN TROUBLE	706	739	680	727	607	661	281	4,401	629
PANIC ALARM/UNK	27	60	31	71	60	74	42	365	52

Falcon District - Yearly Report 1999

	BEAT 51	BEAT 52	BEAT 53	BEAT 54	BEAT 55	BEAT 56	BEAT 57	TOTALS	AVG
ACCIDENT W/O INJURY	265	301	298	342	285	237	103	1,831	262
H&R ACCIDENT W/O INJ..	58	65	58	66	52	52	25	376	54
ACCIDENT WITH INJURY	89	110	115	169	124	123	51	784	112
H&R ACCIDENT W/INJ.	2	4	1	2	3	6	2	20	3
FATAL ACCIDENT	1	1	0	2	0	1	0	5	1
OFFICER INV SHOOTING	0	0	0	0	0	0	0	0	0
OF CR URGENT HELP	0	0	0	0	0	0	0	0	0
SELECT BEAT TOTALS	1,691	1,986	1,928	1,911	1,947	1,831	1,930	15,102	8,729
PERCENT OF CALLS	14.2%	16.3%	15.2%	16.2%	15.5%	14.5%	56.5%	100%	

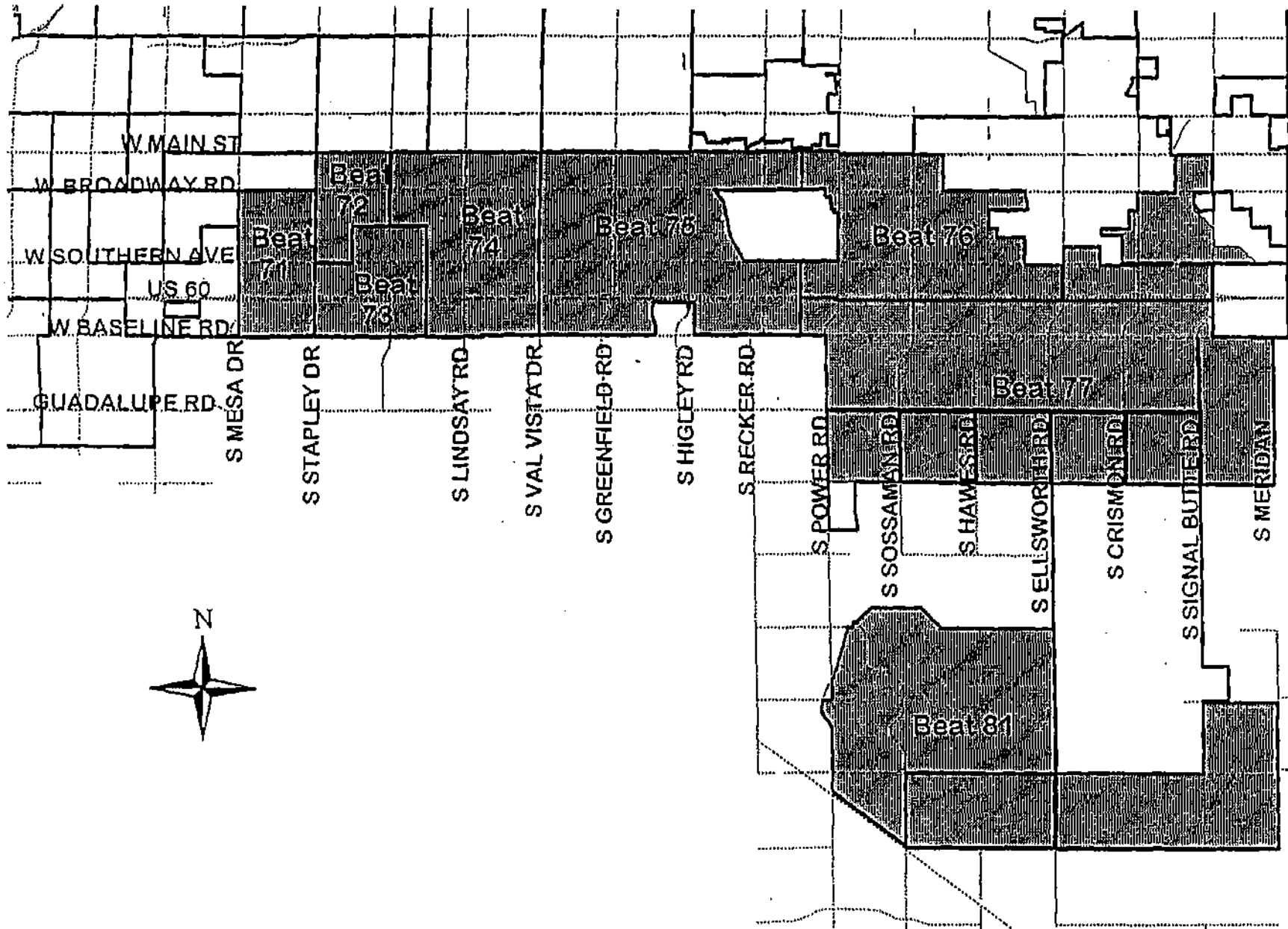

SUPERSTITION DISTRICT - BEATS 71 to 81

**SUPERSTITION CAD/RECORDS BEAT STATISTICS
Yearly Report 1999**

Note: Beat 81 is Williams Gateway Airport

	Overall Superstition Dist. Statistics
DC1 - DR WRITTEN	15,718
DC2 - GOA	7,358
DC3 - UNFOUNDED	778
DC4 - MESSAGE	687
DC5 - CIVIL	25,912
DC6 - FALSE ALARM	4,394
DC7 - TRAFFIC/CROWD	210
DC8 - FI CARD	0
DC9 - TURNED OVER	2,298
DC10 - THEFT < \$50	63
DC11 - NO DISPATCH	33
DC12	0
DCS - SUPPLEMENT	1,619
CANC. - CANCELLED	849
AGENCY ASSIST	23,562
E - INITIATE/ON SCENE	4.3
1 - INITIATE/ON SCENE	8.2
2 - INITIATE/ON SCENE	28.5
3 - INITIATE/ON SCENE	36.9
4 - INITIATE/ON SCENE	69.0
5 - INITIATE/ON SCENE	107.6

NOTE: The first page consists of overall District statistics concerning disposition of calls and average response times to differing call types. The remaining report shows call type counts for the beats.

	BEAT 71	BEAT 72	BEAT 73	BEAT 74	BEAT 75	BEAT 76	BEAT 77	BEAT 81	TOTAL	AVG
UNCODED INCIDENTS	134	230	146	141	183	192	93	51	1119	160
WARRANT ARREST	125	185	192	81	125	155	125	27	938	141
EMERGENCY MESSAGE	4	5	7	16	12	12	10	1	66	9
MOTORIST ASSISTANCE	28	12	16	23	31	20	5	1	135	19
ARMED ROBBERY	9	6	17	8	5	8	8	0	61	9
ARMED ROBB ALARM	29	13	46	10	28	57	37	1	220	31
ARMED ROBB PROG	0	0	4	0	0	0	0	0	4	1
STRONG ARMED ROBB	6	8	3	3	4	5	0	0	29	4
DRUGS	112	188	110	117	70	54	38	23	689	98
TRESPASS	121	87	82	95	74	77	29	9	565	81
FIGHT	87	87	54	77	58	41	26	2	430	61
ASSAULT	47	65	77	80	71	70	27	10	437	62
AWDW	9	16	8	7	10	11	5	1	66	9
SEXUAL ASSAULT	10	8	7	4	6	7	8	0	50	7
PROSTITUTION	3	3	1	1	0	0	0	0	8	1
MOLESTING	13	13	10	16	10	12	19	3	93	13
INDECENT EXPOSURE	15	10	13	9	12	8	8	2	75	11
FORGERY	19	22	41	25	35	49	12	0	203	29
BAD CHECK	2	0	4	2	1	3	1	0	13	2
CREDIT CARD FRAUD	21	19	27	22	39	36	28	1	192	27
DEFRAUD INKEEPER	0	0	1	0	0	1	0	0	2	0
FRAUD INVESTIGATION	0	2	5	5	5	4	1	1	22	3
FOUND PROPERTY	51	85	54	86	74	63	46	10	459	66
DRUNK	10	12	7	12	5	6	1	1	59	8
OBSCENE/HARASS CALLS	14	11	15	15	18	26	6	1	105	15
HARASSMENT	26	15	29	41	31	29	21	5	192	27
THREATS	71	43	75	92	78	81	43	11	483	69
NEIGHBOR TROUBLE	108	86	46	104	39	60	47	10	490	70
CRIMINAL DAMAGE	145	159	183	232	206	205	125	26	1255	179
JUVENILE DISTURB	259	224	259	369	274	233	153	44	1771	253
SUBJECT DISTURB	687	567	492	523	402	371	189	35	3231	462

Superstition District - Yearly Report 1999

	BEAT 71	BEAT 72	BEAT 73	BEAT 74	BEAT 75	BEAT 76	BEAT 77	BEAT 81	TOTAL	AVG
NOISE DISTURB	447	306	255	424	224	142	122	21	1920	274
FAMILY FIGHT	164	116	129	195	107	86	69	11	866	124
SHOTS FIRED	158	108	41	90	55	47	35	2	564	76
SUBJECT WITH GUN	20	17	24	18	19	13	8	0	119	17
SUBJECT WITH KNIFE	6	7	5	2	6	1	3	0	30	4
CIVIL MATTER	405	402	328	480	459	426	219	2	2719	388
CUSTODIAL/ACCESS INTER	11	15	12	42	22	18	27	0	147	21
DRIVE BY SHOOTING	0	0	0	0	0	0	0	0	0	0
GRAFFITI	0	0	0	1	0	0	0	0	1	0
PARTYCREW	0	0	0	0	0	0	0	0	0	0
HOMICIDE	0	1	0	0	0	0	0	0	1	0
BURGLARY ALARM	812	345	549	760	809	912	808	71	4995	714
BURGLARY COMMERCIAL	44	30	46	51	62	56	51	4	340	49
BURGLARY RESIDENTIAL	133	158	93	152	144	126	89	10	895	128
BURGLARY VEHICLE	170	212	226	272	285	224	163	6	1552	222
THEFT COMMERCIAL	97	97	162	135	233	301	125	13	1450	164
THEFT RESIDENTIAL	112	124	124	178	162	139	116	7	955	136
THEFT FROM VEHICLE	41	36	53	58	55	65	34	0	342	49
SHOPLIFTER	15	4	74	38	176	284	17	1	608	87
KIDNAPPING	0	2	1	1	1	3	1	0	9	1
TRAFFIC CONTROL	23	29	44	34	26	34	10	2	200	29
AUTO THEFT	108	91	87	105	121	128	78	7	718	103
AUTO THEFT RECOVERY	54	48	38	31	23	31	25	2	250	36
SPEEDING VEHICLE	7	9	6	13	4	1	13	1	53	8
SUSP OR REVOKED LICENSE	182	340	186	174	194	160	79	32	1315	188
TRAFFIC HAZARD	187	120	203	221	254	235	120	9	1340	191
ILLEGAL PARKING	12	11	27	27	20	16	7	0	120	17
INFO RECEIVED	12	16	11	13	15	15	17	2	99	14
MISSING PERSON	165	172	134	208	134	154	110	61	1077	154
CHILD NEGLECT	24	24	23	20	18	18	20	5	147	21

Superstition District - Yearly Report 1999

	BEAT 71	BEAT 72	BEAT 73	BEAT 74	BEAT 75	BEAT 76	BEAT 77	BEAT 81	TOTALS	AVG
ACCIDENT W/O INJURY	358	310	455	353	440	465	147	14	2,528	361
H&R ACCIDENT W/O INJ..	73	67	76	95	94	96	49	6	550	79
ACCIDENT WITH INJURY	108	120	159	144	182	182	83	3	978	140
H&R ACCIDENT W/INJ.	1	1	0	1	4	2	0	0	9	1
FATAL ACCIDENT	1	0	0	0	0	1	0	0	2	0
OFFICER INV SHOOTING	0	0	0	0	0	0	0	0	0	0
OFCR URGENT HELP	0	2	0	0	0	0	0	0	2	0
SELECT BEAT TOTALS	9,669	9,099	8,593	10,953	9,908	10,001	6,091	963	64,314	9,188
PERCENT OF CALLS	15.0%	14.1%	13.4%	17.0%	15.4%	15.6%	9.5%	1.5%	100%	

* Beat 81 is the area of the Williams Gateway Airport and is not included in the district totals or averages.

APARTMENTS, TOWNHOUSES, CONDOS - CALLS FOR SERVICE LIST
1999
(Sorted by Name)

Citywide Ratio: .80
Level: Variation above or below the Citywide CFS Ratio
*Member of Crime Free Multi-Housing Program

<u>NAME</u>	<u>ADDRESS</u>	<u>UNITS</u>	<u>TYPE</u>	<u>CFS</u>	<u>RATIO</u>	<u>LEVEL</u>
1645 N DATE	1645 N DATE	24	APT	16	.67	-0.13
4328 E CAPRI	4328 E CAPRI AV	60	CONDO	4	.07	-0.73
4329 E CAPRI	4329 E CAPRI AV	32	CONDO	4	.13	-0.68
557 S OLIVE	557 S OLIVE	16	APT	40	2.50	1.70
5925 E UNIVERSITY	5925 E UNIVERSITY DR	22	APT	1	.05	-0.75
605 S COUNTRY CLUB	605 S COUNTRY CLUB DR	12	APT	28	2.33	1.53
61 AND 65 N MAY	61 N MAY	12	APT	10	.83	0.03
8146 E UNIVERSITY DR	8146 E UNIVERSITY DR	28	APT	120	4.29	3.49
ACACIA LAKES*	1960 W KEATING AV	576	APT	372	.65	-0.15
ALHAMBRA HOTEL	43 S MACDONALD	34	APT	46	1.35	0.55
ALL STAR INN	630 W MAIN ST	108	APT	212	1.96	1.16
ALMA PARK*	718 S ALMA SCHOOL RD	106	APT	195	1.84	1.04
ALTA MESA CHATEAUX	5230 E BROWN RD	60	CONDO	23	.38	-0.42
ALTA MESA TOWNHOMES	5505 E MCLELLAN RD	125	TH	28	.22	-0.58
ALTA PLACE APTS	1340 N RECKER RD	152	APT	169	1.11	0.31
ALTA VISTA	1444 N RECKER RD	69	APT	9	.13	-0.67
AMBERWOOD MANOR*	260 W 8TH AV	164	CONDO	269	1.64	0.84
APACHE COURT MOTEL, TP	1859 E MAIN ST	26	APT	6	.23	-0.57
ARCOS DE MESA	1010 N STAPLEY DR	44	APT	25	.57	-0.23
ARIZONA GOLF RESORT*	425 S POWER RD	162	APT	35	.22	-0.58
ASHLAND MANOR APTS	33 S ASHLAND	42	APT	41	.98	0.18
ASPEN RIDGE*	820 E BROWN RD	96	APT	304	3.17	2.37
ASPENS APTS, THE*	650 S COUNTRY CLUB DR	155	APT	276	1.78	0.98
AZTEC SPRINGS APTS*	164 N 74TH ST	304	APT	266	.88	0.08
BAY CLUB AT MESA COVE*	2121 W MAIN ST	474	APT	504	1.06	0.26
BEL-AIRE MANOR	221 E 2ND AV	16	APT	15	.94	0.14
BEL-AIRE MANOR	231 E 2ND AV	16	APT	7	.44	-0.36
BLUERIDGE	436 W 8TH ST	36	APT	96	2.67	1.87
BRIDGEWOOD	930 S DOBSON RD	88	TH	69	.78	-0.02
BRITTANY PLACE*	708 N COUNTRY CLUB DR	87	APT	123	1.41	0.61
BROADWAY GARDENS*	945 W BROADWAY RD	288	APT	204	.71	-0.09
BROADWAY SQUARE	1859 E BROADWAY RD	22	APT	76	3.45	2.65
BROADWAY VILLAGE	2107 W BROADWAY RD	156	APT	133	.85	0.05
BROOKFIELD	1055 N RECKER RD	144	CONDO	97	.67	-0.13
BROOKFIELD WEST 1	6335 E BROWN RD	135	TH	76	.56	-0.24
BROOKSIDE	653 W GUADALUPE RD	66	CONDO	56	.85	0.05
BROOKVIEW	1940 N UNIVERSITY DR	157	APT	219	1.39	0.59
BROWNWOOD TERRACE*	737 E BROWN RD	39	APT	35	.92	0.12
BUENA VISTA	237 S ASHLAND	40	APT	46	1.15	0.35
BUTTERFIELD PARK UNIT IV	645 W 8TH ST	28	APT	86	3.07	2.27
CABRILLO POINT#	522 W 9TH PL	66	APT	16	.24	-0.56
CALUSA TRACE*	6518 E MAIN ST	28	APT	21	.75	-0.05
CAMELOT COUNTRY CLUB	2329 N RECKER RD	122	CONDO	31	.25	-0.55
CAMINO DEL REY	542 S HIGLEY RD	117	TH	20	.17	-0.63
CASA BELLA	444 W 6TH PL	16	APT	1	.06	-0.74
CASA CARRANZA*	1903 N COUNTRY CLUB DR	278	APT	222	.80	0.00
CASA DE LEON	309 S SHOUSE	80	APT	137	1.71	0.91
CASA DE PAZ	131 N HIGLEY RD	138	APT	11	.08	-0.72
CASA MESA ESTATES*	1251 S MESA DR	99	APT	312	3.15	2.35
CENTENNIAL VILLAGE*	130 W BROWN RD	153	APT	52	.34	-0.46
CENTERCREST	1505 N CENTER ST	56	CONDO	12	.21	-0.59
CHELSEA	57 N ALMA SCHOOL RD	84	CONDO	95	1.13	0.33

CHRISTINE PLACE	248 N MACDONALD	49	APT	20	.41	-0.39
CHRISTINE PLACE (ASST LIVING)	239 N ROBSON	50	APT	25	.50	-0.30
CIMMARON*	151 E 1ST ST	210	APT	100	.48	-0.32
CIRCLE TREE*	461 W HOLMES AV	256	CONDO	217	.85	0.05
CITADEL APTS, THE	444 S HIGLEY RD	185	APT	43	.23	-0.57
CITRUS HIGHLANDS*	2020 N WINTERHAVEN	40	APT	28	.70	-0.10
CITRUS VIEW	2165 E UNIVERSITY DR	85	CONDO	56	.66	-0.14
CONCORD CONDOS, THE	424 W BROWN RD	99	CONDO	273	2.76	1.96
CONCORD PLACE	1704 S 39TH ST	52	CONDO	48	.92	0.12
CONCORD VILLAGE	1822 S 39TH ST	77	CONDO	42	.55	-0.25
CONTINENTAL ORCHARD	921 W UNIVERSITY DR	247	CONDO	166	.67	-0.13
CONTINENTAL TH EAST I	1051 S DOBSON RD	221	TH	233	1.05	0.25
COPPER POINTE VILLAS	1111 E BROWN RD	108	APT	55	.51	-0.29
COPPER STATE MOTEL, TP	651 E MAIN ST	20	APT	31	1.55	0.75
CORAL POINT	2343 W MAIN ST	336	APT	260	.77	-0.03
CORNERSTONE	1955 N HORNE	20	APT	16	.80	0.00
CORTINA VISTA	5808 E BROWN RD	153	CONDO	53	.35	-0.45
COUNTRY CLUB COMMONS*	1812 N COUNTRY CLUB DR	70	APT	49	.70	-0.10
COUNTRY CLUB GREENS*	350 W 13TH PL	68	APT	70	1.03	0.23
COUNTRY CLUB HEIGHTS	1500 W 8TH ST	152	CONDO	160	1.05	0.25
COUNTRY COVE	623 S COUNTRY CLUB DR	17	APT	23	1.35	0.55
COUNTRY PARK*	1248 S VINEYARD	96	APT	184	1.92	1.12
COURTYARDS APTS, THE	1111 S SAN JOSE	112	APT	213	1.90	1.10
COVINA COURT	1821 E COVINA ST	164	APT	214	1.30	0.50
CRESTWOOD*	601 S ALMA SCHOOL RD	276	APT	199	.72	-0.08
CROWLEY APTS	432 S MESA DR	18	APT	17	.94	0.14
CYPRESS COMMONS*	447 W 8TH ST	48	CONDO	69	1.44	0.64
DANA	731 W DANA	12	APT	1	.08	-0.72
DANA RANCH VILLAS	3510 E HAMPTON AV	133	TH	39	.29	-0.51
DARTMOOR*	310 N ALMA SCHOOL RD	72	APT	83	1.15	0.35
DARTMOUTH TRACE	602 N MAY	118	CONDO	68	.58	-0.22
DEL CORONADO	843 S LONGMORE	420	APT	539	1.28	0.48
DEL RIO MOTEL	2200 W MAIN ST	63	APT	21	.33	-0.47
DESERT PALMS	152 N 56TH ST	80	APT	1	.01	-0.79
DESERT PALMS	50 W 9TH PL	12	APT	9	.75	-0.05
DESERT PALMS*	210 E BROWN RD	96	APT	155	1.61	0.81
DESERT SPRINGS ESTATES	1229 N ALMA SCHOOL RD	34	TH	19	.56	-0.24
DESERT VIEW APTS*	3030 E BROADWAY RD	126	APT	189	1.50	0.70
DISCOVERY POINT	6210 E ARBOR AV	183	APT	26	.14	-0.66
DOBSON BAY CLUB*	1331 W BASELINE RD	166	CONDO	179	1.08	0.28
DOBSON GLEN (LONGMORE)	2040 S LONGMORE	80	CONDO	94	1.18	0.38
DOBSON GLEN (PENNINGTON)	2121 S PENNINGTON	68	CONDO	77	1.13	0.33
DOBSON GREEN*	1920 W LINDNER AV	152	CONDO	86	.57	-0.23
DOBSON MEADOWS	949 S LONGMORE	156	APT	265	1.70	0.90
DOBSON RANCH	1942 S EMERSON	108	CONDO	67	.62	-0.18
DOBSON SPRINGS	1325 W GUADALUPE RD	120	APT	140	1.17	0.37
DOBSON VILLAGE*	901 S DOBSON RD	226	APT	229	1.01	0.21
DREW	39 E MAIN ST	10	APT	1	.10	-0.70
EASTBROOK TOWNHOUSES	2301 E UNIVERSITY DR	320	TH	349	1.09	0.29
EASTWOOD PARK	520 N STAPLEY DR	146	CONDO	146	1.00	0.20
EDISON PLACE	544 N HORNE	11	APT	1	.09	-0.71
EL DORADO TOWNHOMES	6262 E BROWN RD	92	TH	64	.70	-0.10
EL MADRID*	425 N VINEYARD	30	APT	8	.27	-0.53
EMELITA PLACE	1730 W EMELITA AV	112	APT	122	1.09	0.29
EMERALD SPRINGS*	1820 W LINDNER AV	194	APT	221	1.14	0.34
EMERALD*	1030 S DOBSON RD	324	APT	220	.68	-0.12
EMPARRADO*	132 E BROWN RD	159	APT	128	.81	0.01
EPERNAY*	944 W MAIN ST	336	APT	308	.92	0.12
EUCALYPTUS MANOR APTS	819 N REVERE	22	APT	39	1.77	0.97
EVERGREEN ACRES	56 W 9TH PL	12	APT	18	1.50	0.70
EXETER PLACE	1301 W 8TH ST	52	APT	43	.83	0.03

EXTENSION PLACE	542 S EXTENSION RD	32	CONDO	45	1.41	0.61
FAIRVIEW TERRACE	524 W FAIRWAY DR	16	APT	4	.25	-0.55
FAIRWAY GARDENS	1455 N ALMA SCHOOL RD	40	CONDO	43	1.08	0.28
FALCON GLEN 1	4225 E UNIVERSITY DR	200	APT	216	1.08	0.28
FALCON GLEN 11	220 N GREENFIELD RD	201	APT	257	1.28	0.48
FARMSTEAD*	1415 N COUNTRY CLUB DR	348	APT	182	.52	-0.28
FIESTA PARK VILLAGE (EAST)	839 S WESTWOOD	104	CONDO	62	.60	-0.20
FIESTA PARK VILLAGE (WEST)	818 S WESTWOOD	80	CONDO	40	.50	-0.30
FIESTA POINTE	625 S WESTWOOD	100	CONDO	135	1.35	0.55
FIESTA VILLAS	925 S LONGMORE	52	CONDO	60	1.15	0.35
FIRESIDE	1255 E UNIVERSITY DR	74	APT	178	2.41	1.61
FIRST AVENUE*	633 W 1ST AV	52	APT	67	1.29	0.49
FOUNTAIN OF THE SUN	8001 E BROADWAY RD	709	CONDO	21	.03	-0.77
FOUR PEAKS ESTATES*	2650 E MCKELLIPS RD	96	CONDO	178	1.85	1.05
GARDEN PLACE	1360 W ISABELLA AV	332	APT	163	.49	-0.31
GARDEN VIEW	524 S STAPLEY DR	28	CONDO	30	1.07	0.27
GENTRY'S WALK APTS*	1313 S VAL VISTA DR	176	APT	72	.41	-0.39
GOLDEN HILLS FAIRWAY	7005 E BROADWAY RD	18	CONDO	1	.06	-0.74
GOLDEN HILLS FAIRWAY	7037 E BROADWAY RD	10	CONDO	5	.50	-0.30
GOLDEN HILLS FAIRWAY	7061 E BROADWAY RD	16	CONDO	1	.06	-0.74
GOLDEN HILLS FAIRWAY	709 S POWER RD	18	CONDO	8	.44	-0.36
GOLDEN HILLS FAIRWAY	7129 E BROADWAY RD	16	CONDO	7	.44	-0.36
GOLFVIEW	245 N 56TH ST	56	APT	1	.02	-0.78
GOOD SHEPARD	5848 E UNIVERSITY DR	100	APT	1	.01	-0.79
GREENFIELD GLEN	1021 S GREENFIELD RD	208	CONDO	14	.07	-0.73
GREENFIELD RETIREMENT	723 E 2ND AV	122	APT	34	.28	-0.52
GREENWOOD*	1640 W UNIVERSITY DR	97	APT	1	.01	-0.79
HALLCRAFT VILLAS	948 S ALMA SCHOOL RD	160	CONDO	174	1.09	0.29
HAMPTON COURT	426 W 9TH ST	26	APT	48	1.85	1.05
HANCOCK	715 E BROWN RD	25	APT	50	2.00	1.20
HEATHER BROOK APTS*	4230 E UNIVERSITY DR	144	APT	179	1.24	0.44
HERITAGE POINTE	2055 E BROADWAY RD	148	APT	171	1.16	0.36
HIDDEN VILLAGE	1006 W MAIN ST	84	APT	175	2.08	1.28
HOHOKAM HILLS	619 E JENSEN ST	101	CONDO	76	.75	-0.05
HOHOKAM HILLS	630 E JENSEN ST	93	CONDO	101	1.09	0.29
HOHOKAM VILLAGE	155 W BROWN RD	161	APT	18	.11	-0.69
HOLIDAY VILLA	44 S HORNE	20	APT	37	1.85	1.05
HOMESTEAD ESTATES	3134 E MCKELLIPS RD	221	TH	130	.59	-0.21
HORNE AVE PATIO HOMES	1535 N HORNE	127	ATIO HOME	103	.81	0.01
HUNTER'S POINT CONDOS	3716 E UNIVERSITY DR	36	CONDO	18	.50	-0.30
INDIAN SPRINGS VILLAGE (EAST)	1031 S STEWART	232	APT	207	.89	0.09
INDIAN SPRINGS VILLAGE (WEST)	1030 S STEWART	230	APT	217	.94	0.14
INDIGO GARDENS	1625 N DATE	27	CONDO	16	.59	-0.21
INGLEWOOD VILLAGE*	1050 S LONGMORE	432	APT	445	1.03	0.23
IRVING M,ANOR	31 W 2ND ST	20	APT	4	.20	-0.60
IVY GARDENS	1725 N DATE	70	CONDO	34	.49	-0.31
IVY MEADOWS	434 W IVYGLEN ST	22	APT	71	3.23	2.43
IVYGLEN*	465 W IVYGLEN ST	92	CONDO	178	1.93	1.13
J & W	106 W 9TH PL	12	APT	45	3.75	2.95
J & W	128 W 9TH PL	10	APT	23	2.30	1.50
KACHINA MANOR	607 W 8TH ST	12	APT	6	.50	-0.30
L & S*	45 N LYN RAE DR	16	APT	46	2.88	2.08
LA CASA MESA	1224 E EVERGREEN ST	86	CONDO	203	2.36	1.56
LA CASCADE	441 N LESUEUR	12	APT	21	1.75	0.95
LA JOLLA COVE	2855 S EXTENSION RD	124	CONDO	84	.68	-0.12
LA MARIPOSA	1440 S VAL VISTA DR	222	APT	226	1.02	0.22
LA MESA VILLAGE*	655 S MESA DR	256	APT	443	1.73	0.93
LA MESITA	2266 W ELLA ST	16	APT	20	1.25	0.45
LA MESITA MOTEL	2254 W MAIN ST	38	APT	37	.97	0.17
LA MIRAGE	450 S VALENCIA	184	APT	118	.64	-0.16
LA PETITE CHATEAU*	1254 E BROADWAY RD	89	APT	57	.64	-0.16

LA VALENCIA	3320 E UNIVERSITY DR	240	APT	223	.93	0.13
LA VALENCIA	423 N CRESTON	120	APT	123	1.03	0.23
LAKEVIEW @ SUPERSTITION SPR	17205 E SUPERSTITION SPRING	676	APT	5	.01	-0.79
LAKEVIEW @ SUPERSTITION SPR	17205 E SUPERSTITION SPRING	676	APT	56	.08	-0.72
LAKEVIEW AT SUPERSTITION SPR	1849 S POWER RD	676	APT	185	.27	-0.53
LAKEVIEW AT SUPERSTITION SPR	17125 E SUPERSTITION SPRING	676	APT	4	.01	-0.79
LAKEVIEW AT SUPRSTITION SPR	17125 E SUPERSTITION SPRING	676	APT	62	.09	-0.71
LAMAR	215 E 1ST AV	18	APT	41	2.28	1.48
LANDINGS CONDOS, THE	2208 W LINDNER AV	398	CONDO	19	-.05	-0.75
LEMON TREE*	1750 S ALMA SCHOOL RD	72	APT	52	.72	-0.08
LINDSAY VILLAS	2850 E BASELINE RD	32	CONDO	31	.97	0.17
LOS RACIMOS	540 N MAY	259	CONDO	210	.81	0.01
MADERA POINT*	445 S DOBSON RD	256	APT	175	-.68	-0.12
MAHONEY MANOR	845 E MAHONEY AV	28	APT	40	1.43	0.63
MALIBU MANOR*	740 E 3RD AV	28	APT	33	1.18	0.38
MARICOPA INN	3 E MAIN ST	64	APT	22	.34	-0.46
MARLBOROUGH MESA VILLAS*	2834 S EXTENSION RD	160	CONDO	72	.45	-0.35
MATEO VILLAGE	1750 E MATEO CI	18	CONDO	29	1.61	0.81
MCKELLIPS MANOR#	205 W MCKELLIPS RD	30	CONDO	53	1.77	0.97
MEADOWS APTS*	2151 E SOUTHERN AV	306	APT	289	.94	0.14
MELODY VILLA	1310 S PINA	52	CONDO	116	2.23	1.43
MELODY VILLA	1402 S PINA	10	CONDO	14	1.40	0.60
MESA CORONADO*	1432 W EMERALD AV	187	CONDO	208	1.11	0.31
MESA DRIVE	435 E 2ND ST	44	APT	41	.93	0.13
MESA DRIVE APTS	350 E 5TH AV	16	APT	25	1.56	0.76
MESA GRANDE CONDOS	1927 E HAMPTON AV	132	CONDO	134	1.02	0.22
MESA MADRID TOWNHOMES*	225 N STANDAGE	150	TH	174	1.16	0.36
MESA MOUNTAIN VIEW*	830 N ALMA SCHOOL RD	44	APT	49	1.11	0.31
MESA OASIS INN	2150 W MAIN ST	18	APT	21	1.17	0.37
MESA PARK	225 N POMEROY	18	TH	43	2.39	1.59
MESA PINES	425 E BROWN RD	30	APT	78	2.60	1.80
MESA RIDGE*	2145 W BROADWAY RD	256	APT	401	1.57	0.77
MESA RIDGE*	530 S DOBSON RD	240	APT	429	1.79	0.99
MESA SHADOWS	332 N DOBSON RD	37	TH	8	.22	-0.58
MESA SILVERCREST	255 E 6TH ST	82	APT	53	.65	-0.15
MESA SUMMIT*	505 S ROOSEVELT RD	185	APT	124	.67	-0.13
MESA TOWN SQUARE*	241 E 1ST AV	44	APT	65	1.48	0.68
MEZONA MOTOR HOTEL	250 W MAIN ST	147	APT	41	.28	-0.52
MILES MOTEL & APTS	5911 E MAIN ST	84	APT	110	1.31	0.51
MISSION SQUARE	1235 N SUNNYVALE	115	CONDO	14	.12	-0.68
MON-DAK APTS	3750 E MAIN ST	35	APT	8	.23	-0.57
MONTE CARLO	320 W BROWN RD	48	APT	50	1.04	0.24
MONTEREY POINT*	510 S EXTENSION RD	244	CONDO	140	.57	-0.23
MOONDANCE TOWNHOMES	7006 E JENSEN ST	177	TH	61	.34	-0.46
MOORINGS AT MESA COVE*	1233 N MESA DR	407	APT	340	.84	0.04
NEWPORT MESA*	1620 W SOUTHERN AV	156	APT	216	1.38	0.58
NORTH COUNTRY CLUB*	1505 N COUNTRY CLUB DR	92	APT	71	.77	-0.03
NORTHGATE GARDENS APT	1540 E MCKELLIPS RD	72	APT	7	.10	-0.70
NORTHGROVE	2848 E BROWN RD	52	CONDO	36	.69	-0.11
NORTHPOINT 1	5135 E EVERGREEN ST	120	CONDO	165	1.38	0.58
NORTHPOINT 2	5136 E EVERGREEN ST	152	CONDO	112	.74	-0.06
NORTHWOOD PARK	222 W BROWN RD	120	CONDO	99	.83	0.02
OFF BROADWAY*	546 S COUNTRY CLUB DR	410	APT	249	.61	-0.19
OLD WEST MANOR	629 N MESA DR	48	CONDO	35	.73	-0.07
OLD WEST MANOR II	3030 S ALMA SCHOOL RD	36	CONDO	18	.50	-0.30
OLIVE	447 S OLIVE	12	APT	7	.58	-0.22
ORANGE GROVE SOUTH	4104 E BROADWAY RD	416	APT	333	.80	0.00
ORANGE GROVE*	111 N GILBERT RD	400	APT	440	1.10	0.30
ORANGEWOOD	136 W 9TH PL	11	APT	14	1.27	0.47
ORCHARD APTS, THE	108 N GREENFIELD RD	696	APT	111	.16	-0.64
PACE EAST	2155 W FARMDALE	23	TH	1	.04	-0.76

PACE EAST	944 S VALENCIA	28	TH	16	.57	-0.23
PACE EAST	950 S VALENCIA	28	TH	11	.39	-0.41
PALM COVE	950 W MAIN ST	76	APT	294	3.87	3.07
PALM FOUNTAINS	141 N DATE	64	CONDO	32	.50	-0.30
PALM GARDENS	1915 E BROADWAY RD	96	APT	181	1.89	1.09
PALMS AT MESA APTS, THE*	324 S HORNE	148	APT	245	1.66	0.86
PARADISE PALMS	43 N HARRIS DR	48	APT	19	.40	-0.40
PARK AT VISTA VALLEY, THE*	850 S LONGMORE	192	APT	228	1.19	0.39
PARK AT VISTA VALLEY, THE*	922 S LONGMORE	164	APT	145	.88	0.08
PARK CENTRE	945 N PASADENA	164	PH	63	.38	-0.42
PARK CENTRE CASITAS	1001 N PASADENA	198	CONDO	76	.38	-0.42
PARK MESA*	504 S HALL	32	APT	16	.50	-0.30
PARK RIDGE	1809 E BROADWAY RD	10	APT	17	1.70	0.90
PARK RIDGE	1829 E BROADWAY RD	14	APT	21	1.50	0.70
PARK TERRACE	1033 S LONGMORE	320	APT	438	1.37	0.57
PARK VIEW I	1628 E BROADWAY RD	36	APT	118	3.28	2.48
PARK VIEW II	344 S WILLIAMS	24	APT	81	3.38	2.58
PARK VILLA	1547 E BROADWAY RD	42	APT	61	1.45	0.65
PARK VILLAGE EAST	226 N HOBSON	59	APT	115	1.95	1.15
PARK VILLAGE WEST	520 E 2ND ST	59	APT	105	1.78	0.98
PARKLINKS TOWNHOMES	5445 E MCKELLIPS RD	56	TH	11	.20	-0.60
PARKSIDE APTS*	325 W 5TH ST	87	APT	90	1.03	0.23
PARKVIEW	644 N CENTER ST	14	APT	16	1.14	0.34
PEAR TREE*	1850 S ALMA SCHOOL RD	91	APT	87	.96	0.16
PEBBLE CREEK APTS*	950 E SOUTHERN AV	122	APT	81	.66	-0.14
PECAN TREE APTS	448 S MESA DR	24	APT	36	1.50	0.70
PECAN TREE MANOR	102 W 9TH PL	11	APT	21	1.91	1.11
PENNY LANE APTS*	544 E SOUTHERN AV	136	APT	227	1.67	0.87
PENNY TREE*	125 W 2ND AV	66	APT	71	1.08	0.28
PENNY TREE*	232 S MACDONALD	145	APT	23	23.00	22.20
PEPPERTREE	1318 S VINEYARD	96	APT	96	1.00	0.20
FINE GARDENS	206 W SOUTHERN AV	56	APT	40	.71	-0.09
PINES APTS, THE*	1050 W 8TH AV	194	APT	183	.94	0.14
PLAZA DE CASA	910 N CENTER ST	24	CONDO	21	.88	0.08
PRIVADO PARK*	1840 W EMELITA AV	352	APT	318	.90	0.10
QUAIL CREEK	1651 S DOBSON RD	269	APT	128	.48	-0.32
QUAIL VISTA VILLAGE	3719 E INVERNESS AV	30	CONDO	91	3.03	2.23
RAMELEWOOD	30 E BROWN RD	171	CONDO	74	.43	-0.37
RANCHO PALOS VERDES*	225 N GILBERT RD	152	APT	109	.72	-0.08
RED MOUNTAIN VILLA	1951 N 64TH ST	29	CONDO	16	.55	-0.25
RED MOUNTAIN VILLAGE	2610 N RECKER RD	28	APT	56	2.00	1.20
REFLECTIONS AT RED MOUNTAIN*	2601 E MCKELLIPS RD	256	APT	165	.64	-0.16
RICK'S APTS	410 S QUINN	12	APT	?	.58	-0.22
RICK'S APTS	420 S QUINN	12	APT	2	.17	-0.63
RICK'S APTS	430 S QUINN	13	APT	2	.15	-0.65
RICK'S APTS	440 S QUINN	13	APT	2	.15	-0.65
RICK'S APTS	450 S QUINN	13	APT	1	.08	-0.72
RICK'S APTS	460 S QUINN	12	APT	1	.08	-0.72
RICK'S APTS	502 S QUINN	12	APT	3	.25	-0.55
RIGGS CIRCLE	510 N HORNE	25	APT	33	1.32	0.52
RIO VISTA	454 W BROWN RD	80	APT	218	2.73	1.93
RIVIERA POINTE*	1800 E COVINA ST	264	APT	389	1.47	0.67
ROBSON PLACE	231 N ROBSON	20	CONDO	9	.45	-0.35
ROSEWOOD VILLA*	210 N ALMA SCHOOL RD	76	APT	92	1.21	0.41
ROYAL PALMS*	1825 N STAPLEY DR	152	APT	31	.20	-0.60
SAN JOSE MANOR	1112 S SAN JOSE	176	APT	121	.69	-0.11
SAN MONTGO APTS#	6745 E SUPERSTITION SPRING	240	APT	56	.23	-0.57
SAN MONTIGO APTS#	6745 E SUPERSTITION SPRING	240	APT	5	.02	-0.78
SAN TAN	20 S MACDONALD	21	APT	43	2.05	1.25
SANDAL RIDGE	645 N COUNTRY CLUB DR	196	APT	369	1.88	1.08
SANDS APTS, THE*	2305 E MAIN ST	142	APT	253	1.78	0.98

SANDSTONE*	1727 W EMELITA AV	238	APT	146	.61	-0.19
SANTA FE VILLAS	715 S EXTENSION RD	32	CONDO	50	1.56	0.76
SARATOGA*	2240 W UNIVERSITY DR	129	APT	137	1.06	0.26
SARATOGA*	2340 W UNIVERSITY DR	157	APT	121	.77	-0.03
SHADOW CREEK*	2354 W UNIVERSITY DR	266	APT	226	.85	0.05
SHADOW RUN*	56 N EXTENSION RD	80	APT	189	2.36	1.56
SHADOW TREE	244 S LAZONA DR	16	APT	68	4.25	3.45
SHERWOOD	54 S ALLEN	16	APT	1	.06	-0.74
SHOREBIRD	1362 S VINEYARD	240	APT	167	.70	-0.10
SHOWBOAT	430 W 3RD ST	12	APT	21	1.75	0.95
SIERRA MADRE	900 N COUNTRY CLUB DR	62	APT	146	2.35	1.55
SIERRA MADRE III	461 W 9TH ST	93	APT	47	.51	-0.29
SIERRA SHADOWS	622 S STAPLEY DR	24	APT	65	2.71	1.91
SIESTA VILLA	1050 N HORNE	68	APT	71	1.04	0.24
SILVER CREEK APTS	124 N 67TH ST	110	APT	54	.49	-0.31
SIR LANCELOT VILLAGE	725 S POWER RD	18	APT	12	.67	-0.13
SKYVIEW MESA UNIT I	830 S DOBSON RD	112	TH	116	1.04	0.24
SKYVIEW MESA UNIT II	720 S DOBSON RD	128	CONDO	196	1.53	0.73
SOUTH BANK	214 N GILBERT RD	113	APT	289	2.56	1.76
SOUTHERN GARDENS	960 W SOUTHERN AV	150	APT	155	1.03	0.23
SPANISH ARCOS*	206 W 10TH AV	15	APT	14	.93	0.13
SPANISH ARCOS*	220 W 10TH AV	15	APT	9	.60	-0.20
SPANISH ARCOS*	236 W 10TH AV	16	APT	12	.75	-0.05
SPANISH ARCOS*	250 W 10TH AV	15	APT	20	1.33	0.53
SPANISH ARCOS*	264 W 10TH AV	15	APT	10	.67	-0.13
SPANISH ARCOS*	312 W 10TH AV	15	APT	18	1.20	0.40
SPANISH PALMS	224 S ALLEN	28	APT	30	1.07	0.27
SPRINGS OF EAST MESA APTS,	76220 E BROADWAY RD	186	APT	48	.26	-0.54
SPRINGS OF NORTH MESA	262 E BROWN RD	174	APT	67	.39	-0.41
STANDAGE PLACE*	310 N STANDAGE	6	APT	6	1.00	0.20
STANDAGE PLACE*	316 N STANDAGE	6	APT	4	.67	-0.13
STANDAGE PLACE*	326 N STANDAGE	23	APT	11	.48	-0.32
STAPLEY COURT NORTH	1610 N STAPLEY DR	12	TH	1	.08	-0.72
STAPLEY GREENS	1836 N STAPLEY DR	199	TH	58	.29	-0.51
STAPLEY MANOR	819 S STAPLEY DR	18	APT	30	1.67	0.87
STAPLEY PLACE	654 S STAPLEY DR	60	APT	82	1.37	0.57
STAPLEY VILLAGE	339 S STAPLEY DR	24	APT	18	.75	-0.05
STONEBRIDGE GARDENS	921 S VAL VISTA DR	183	TH	188	1.03	0.23
STONEGATE*	825 S ALMA SCHOOL RD	222	APT	184	.83	0.03
STRATFORD PLACE	235 N 22ND PL	49	APT	27	.55	-0.25
SUMMER PLACE TERRACE	2455 E BROADWAY RD	130	CONDO	101	.78	-0.02
SUN COURT	5825 E UNIVERSITY DR	32	APT	1	.03	-0.77
SUN CREST	111 N MESA DR	32	APT	117	3.66	2.86
SUN CREST	130 N LESUEUR	52	APT	162	3.12	2.32
SUN CREST	144 N LESUEUR	10	APT	18	1.80	1.00
SUN GARDENS	860 E BROWN RD	80	CONDO	297	3.71	2.91
SUN MESA CARE CENTER	7255 E BROADWAY RD	198	APT	75	.38	-0.42
SUN RIDGE MANOR	1107 E UNIVERSITY DR	45	APT	128	2.84	2.04
SUN TERRACE	1825 W EMELITA AV	216	APT	43	.20	-0.60
SUN VALLEY GARDEN APTS	234 N 75TH ST	112	APT	80	.71	-0.09
SUNCREST MANOR	551 S LESUEUR	7	APT	5	.71	-0.09
SUNCREST MANOR	559 S LESUEUR	7	APT	4	.57	-0.23
SUNCREST MANOR	603 S LESUEUR	6	APT	10	1.67	0.87
SUNCREST MANOR	609 S LESUEUR	6	APT	8	1.33	0.53
SUNFIELD TOWNHOMES	1111 N 64TH ST	71	TH	34	.48	-0.32
SUNLAND MANOR APTS	1050 S STAPLEY DR	70	APT	74	1.06	0.26
SUNLAND TOWERS	425 S PARKCREST	18	CONDO	2	.11	-0.69
SUNLAND TOWERS	453 S PARKCREST	18	CONDO	1	.06	-0.74
SUNLAND TOWERS	515 S PARKCREST	16	CONDO	5	.31	-0.49
SUNLAND VILLAGE EAST	2064 S FARNSWORTH DR	117	CONDO	15	.13	-0.67
SUNLAND VILLAGE EAST	2105 S ZINNIA	16	CONDO	1	.06	-0.74

SUNLAND VILLAGE EAST	2310 S FARNSWORTH DR	58	CONDO	3	.05	-0.75
SUNLAND VILLAGE EAST	2311 S FARNSWORTH DR	70	CONDO	3	.04	-0.76
SUNLAND VILLAGE EAST	7950 E KEATS AV	110	CONDO	7	.06	-0.74
SUNLAND VILLAGE EAST	8020 E KEATS AV	68	CONDO	5	.07	-0.73
SUNLAND VILLAGE EAST	8160 E KEATS AV	44	CONDO	5	.11	-0.69
SUNLAND VILLAGE EAST	8161 E KEATS AV	12	CONDO	2	.17	-0.63
SUNLAND VILLAGE EAST	8255 E KIVA AV	38	CONDO	5	.13	-0.67
SUNLAND VILLAGE EAST	8256 E KIVA AV	16	CONDO	2	.13	-0.68
SUNLAND VILLAGE EAST	8261 E KEATS AV	16	CONDO	1	.06	-0.74
SUNLAND VILLAGE EAST GOLF	C07755 E LAGUNA AZUL AV	106	CONDO	3	.03	-0.77
SUNLAND VILLAS 1	440 S PARKCREST	86	APT	10	.12	-0.68
SUNLAND VILLAS 2	4501 E CAROL AV	38	APT	7	.18	-0.62
SUNLAND VILLAS 2	4502 E CAROL AV	24	APT	2	.08	-0.72
SUNLAND VILLAS 3 CONDOS	520 S GREENFIELD RD	42	CONDO	2	.05	-0.75
SUNLAND VILLAS NORTH	4740 E BROADWAY RD	45	APT	10	.22	-0.58
SUNNYBROOK I	138 W 1ST ST	56	APT	10	.18	-0.62
SUNNYBROOK II	123 N ROBSON	46	APT	12	.26	-0.54
SUNRIDGE	1850 S WESTWOOD	48	PH	8	.17	-0.63
SUNRIDGE	1930 S WESTWOOD	48	PH	26	.54	-0.26
SUNRIDGE*	1666 S EXTENSION RD	304	APT	166	.55	-0.25
SUNVALLEY CASITAS	145 N 74TH ST	112	CONDO	31	.28	-0.52
SUNVALLEY VILLAS	205 N 74TH ST	26	CONDO	9	.35	-0.45
SUPERSTITION VILLAS APTS*	2055 E HAMPTON AV	249	APT	251	1.01	0.21
SUPERSTITION VISTA APTS	450 S ACACIA	316	APT	432	1.37	0.57
SYCAMORE SHADOWS*	1120 S SYCAMORE	120	APT	127	1.06	0.26
SYCAMORE SQUARE	302 N SYCAMORE	30	TH	22	.73	-0.07
TAHITIAN PALMS	120 N BEVERLY	12	APT	17	1.42	0.62
TALL PALMS MOTEL	1554 W MAIN ST	37	APT	58	1.57	0.77
TAMARRON VILLAGE	455 S MESA DR	80	CONDO	53	.66	-0.14
TASCHNER APTS	409 E 9TH AV	4	APT	2	.50	-0.30
TASCHNER APTS	417 E 9TH AV	4	APT	1	.25	-0.55
TASCHNER APTS	423 E 9TH AV	4	APT	4	1.00	0.20
TASCHNER APTS	429 E 9TH AV	4	APT	1	.25	-0.55
TASCHNER APTS	435 E 9TH AV	4	APT	4	1.00	0.20
TASCHNER APTS	441 E 9TH AV	4	APT	5	1.25	0.45
TASCHNER APTS	453 E 9TH AV	3	APT	7	2.33	1.53
TASCHNER APTS	457 E 9TH AV	4	APT	1	.25	-0.55
TASCHNER MANOR APTS	410 E 9TH AV	20	APT	20	1.00	0.20
TEMPLE VIEW	501 E 2ND AV	35	CONDO	6	.17	-0.63
TERRA VIDA	150 S ROOSEVELT RD	385	APT	418	1.09	0.29
THREE FOUNTAINS	1550 N STAPLEY DR	124	CONDO	36	.29	-0.51
TIBURON APTS*	901 S COUNTRY CLUB DR	582	APT	368	.63	-0.17
TIERRA DEL SOL APTS*	1711 S EXTENSION RD	276	APT	269	.97	0.17
TIFFANY SQUARE	2929 E BROADWAY RD	106	CONDO	30	.28	-0.52
TOWERS APTS, THE*	22 N ROBSON	197	APT	23	.12	-0.68
TOWN AND COUNTRY	315 W 10TH PL	19	APT	10	.53	-0.27
TOWN HOUSE	245 W 10TH PL	16	APT	9	.56	-0.24
TRADITIONS, THE	4450 E SOUTHERN AV	160	APT	96	.60	-0.20
TRAILS END APTS	1653 S HARRIS DR	208	APT	184	.88	0.08
TRAVELDGE MOTEL	22 S COUNTRY CLUB DR	39	APT	22	.56	-0.24
TRI-CITY INN	1504 W MAIN ST	28	APT	36	1.29	0.49
UNIVERSITY GREEN*	265 N GILBERT RD	398	APT	224	.56	-0.24
VAL VISTA CONDOS	3440 E SOUTHERN AV	200	CONDO	95	.48	-0.33
VAL VISTA GARDENS*	3443 E UNIVERSITY DR	96	APT	93	.97	0.17
VAL VISTA VILLAS	3755 E BROADWAY RD	111	TH	112	1.01	0.21
VILLA DE LA FUENTE	834 E FOUNTAIN ST	16	CONDO	14	.88	0.08
VILLA DEL SOL	2030 E BROADWAY RD	20	APT	29	1.45	0.65
VILLA DEL SOL	2102 E BROADWAY RD	20	APT	57	2.85	2.05
VILLA FIESTA#	1515 S EXTENSION RD	438	APT	267	.61	-0.19
VILLA LE'QUANTE	1500 N MARKDALE	70	CONDO	25	.36	-0.44
VILLA MESA#	600 S DOBSON RD	430	TH	315	.73	-0.07

VILLAGE AT APACHE WELLS	5518 E LINDSTROM LN	162	CONDO	8	.05	-0.75
VILLAGE AT PARK CENTRE*	930 N MESA DR .	208	APT	178	.86	0.06
VILLAGE GREEN*	1045 S SAN JOSE	108	APT	64	.59	-0.21
VILLAGE MOTEL	2130 W MAIN ST	27	APT	98	3.63	2.83
VILLAGE PARK	2130 W CAMINO ST	12	CONDO	2	.17	-0.63
VILLAGE PARK	525 N MAY	28	CONDO	32	1.14	0.34
VILLAGE PARK	555 N MAY	36	CONDO	39	1.08	0.28
VILLAGE PARK	601 N MAY	36	CONDO	68	1.89	1.09
VILLAGE PARK	633 N MAY	36	CONDO	77	2.14	1.34
VILLAGE PARK	712 N SANTA BARBARA	32	CONDO	94	2.94	2.14
VILLAGES APTS, THE	1101 S SYCAMORE	96	APT	59	.61	-0.19
VILLAS MESA	1342 W EMERALD AV	204	CONDO	178	.87	0.07
VILLAS VALENCIA	2059 E BROWN RD	85	APT	27	.32	-0.48
VISTA POINTE#	2940 E BROADWAY RD	186	APT	221	1.19	0.39
VISTA VILLAGES	1915 S 39TH ST	130	CONDO	68	.52	-0.28
VISTA VILLAGES 2	1811 S 39TH ST	101	CONDO	69	.68	-0.12
WARREN HOUSE*	1457 W UNIVERSITY DR	111	APT	64	.58	-0.22
WARREN PARK#	1433 W UNIVERSITY DR	92	APT	90	.98	0.18
WATER WORKS	1645 W BASELINE RD	204	CONDO	210	1.03	0.23
WATERFORD PLACE*	1055 W BASELINE RD	200	APT	145	.73	-0.08
WEST WINDS (DESERT WINDS)	2220 W DORA ST	60	CONDO	80	1.33	0.53
WESTBROOK	510 N ALMA SCHOOL RD	198	CONDO	197	.99	0.19
WESTERN SUN	615 S WILLIAMS	60	APT	106	1.77	0.97
WESTWOOD VILLAGE	523 W 9TH ST	69	APT	159	2.30	1.50
WESTWOOD VILLAGE	524 W 9TH ST	27	APT	40	1.48	0.68
WHISPERING PINES	35 W BROWN RD	255	APT	57	.22	-0.58
WILLOW FARC	745 N DOBSON RD	84	CONDO	81	.96	0.16
WINDMERE APTS	2020 E INVERNESS AV	224	APT	215	.96	0.16
WINDSCAPE*	550 E MCKELLIPS RD	316	APT	148	.47	-0.33
WINDSOR SHADOWS	441 S MAPLE	164	CONDO	117	.71	-0.09
WINTERCOVE	2010 N LAZONA DR	36	APT	32	.89	0.09
WOOD CREEK	1718 S LONGMORE	120	TH	67	.56	-0.24
WOODBRIDGE LAKES	1360 E BROWN RD	39	CONDO	18	.46	-0.34
WOODCREEK APTS	1710 S GILBERT RD	432	APT	369	.85	0.05
WOODGLEN SQUARE I	623 W GUADALUPE RD	192	CONDO	158	.82	0.02
WOODGLEN SQUARE II*	533 W GUADALUPE RD	280	CONDO	264	.94	0.14
WOODRIDGE	2259 W ELLA ST	30	APT	83	2.77	1.97
WOODSTREAM VILLAGE*	1230 N MESA DR	157	APT	107	.68	-0.12

52461

42418

0.8

HOTEL/MOTEL - CALLS FOR SERVICE LIST
1999
(Sorted by Name)

Citywide Ratio: .75
 Level: Variation above or below the Citywide CFS Ratio
 * Certified in the Crime Free Multi-Housing Program
 # Participates (not certified) in the Crime Free Multi-Housing Program

NAME	ADDRESS	ROOMS	CFS	RATIO	LEVEL
AAA MOTEL	6763 E MAIN ST	22.00	14	.59	-0.16
ARIZONA GOLF RESORT#	425 S POWER RD	186.00	35	.19	-0.56
BUCKHORN MINERAL WELLS	5900 E MAIN ST	14.00	14	.86	0.11
BUDGET INN	106 S COUNTRY CLUB DR	16.00	42	2.63	1.88
BUDGET SUITES MOTEL	537 S COUNTRY CLUB DR	32.00	44	1.34	0.59
BUDGET SUITES OF AMERICA	825 S DOBSON RD	222.00	265	1.12	0.37
BW DOBSON RANCH INN#	1666 S DOBSON RD	213.00	37	.17	-0.58
BW MESA INN#	1625 E MAIN ST	99.00	105	1.01	0.26
BW MEZONA*	250 W MAIN ST	136.00	41	.30	-0.45
BW SUPERSTITION SPRINGS INN*	1342 S POWER RD	59.00	25	.42	-0.33
CENTERBAR MOTEL	5402 E MAIN ST	36.00	11	.31	-0.44
CIRCLE RE LODGE	6547 E MAIN ST	15.00	1	.07	-0.68
CLOVERDALE MOTEL	1302 W MAIN ST	34.00	5	.15	-0.60
COLONADE MOTEL	5440 E MAIN ST	70.00	100	1.33	0.58
COPPER STATE MOTEL	651 E MAIN ST	19.00	32	1.63	0.88
COUNTRY INN AND SUITES*	6650 E SUPERSTITION SPRING	126.00	25	.15	-0.60
COURTYARD BY MARRIOTT#	1221 S WESTWOOD	149.00	25	.17	-0.58
DAYS INN EAST MESA#	5531 E MAIN ST	61.00	12	.20	-0.55
DAYS INN MESA*	333 W JUANITA AV	124.00	61	.47	-0.28
DEL RIO MOTEL	2200 W MAIN ST	57.00	25	.37	-0.38
EL RANCHO MOTEL	719 E MAIN ST	24.00	42	1.75	1.00
EXTENDED STAY AMERICA	455 W BASELINE RD	104.00	90	.87	0.12
FAIRFIELD INN	1405 S WESTWOOD	66.00	30	.45	-0.30
FOUNTAIN MOTEL	6240 E MAIN ST	12.00	10	.83	0.08
FRONTIER MOTEL*	1307 E MAIN ST	22.00	24	1.09	0.34
HAMPTON INN	1563 S GILBERT RD	116.00	43	.37	-0.38
HIWAY HOST MOTEL	1260 W MAIN ST	14.00	23	2.64	0.89
HOLIDAY INN	1600 S COUNTRY CLUB DR	245.00	435	1.73	0.98
HOLIDAY INN EXPRESS	5700 E MAIN ST	118.00	17	.12	-0.63
HOLIDAY MOTEL	6444 E MAIN ST	12.00	11	.83	0.08
HOMESTEAD VILLAGE#	1920 W ISABELLA AV	122.00	46	.37	-0.38
KIVA LODGE	668 W MAIN ST	17.00	31	1.41	0.66
LA QUINTA INN & SUITES (Grove)	902 W GROVE AV	125.00	64	.50	-0.25
LA QUINTA INN & SUITES#	6530 E SUPERSTITION SPRING	107.00	31	.24	-0.51
LOST DUTCHMAN MOTEL	560 S COUNTRY CLUB DR	36.00	26	.72	-0.03
MAJESTIC GUEST INN	1554 W MAIN ST	36.00	63	1.61	0.86
MESA OASIS INN & MOTEL	2150 W MAIN ST	15.00	21	1.40	0.65
MESA PAVILLION HILTON#	1011 W HOLMES AV	253.00	97	.38	-0.37
MILES MOTEL	5911 E MAIN ST	39.00	112	2.82	2.07
MOTEL 6 (Hampton)	336 W HAMPTON AV	162.00	219	1.25	0.50
MOTEL 6 (Main St.)*	630 W MAIN ST	104.00	237	2.04	1.29
MOTEL 6#	1511 S COUNTRY CLUB DR	91.00	136	1.47	0.72
PLAINSMAN MOTEL	1338 W MAIN ST	14.00	19	1.36	0.61
QUALITY INN OF MESA	951 W MAIN ST	100.00	20	.20	-0.55
RAMADA INN SUITES*	1410 S COUNTRY CLUB DR	120.00	57	.47	-0.28
RAMADA LIMITED	1750 E MAIN ST	64.00	105	1.47	0.72
RAWLS MOTEL	1310 W MAIN ST	48.00	25	.50	-0.25
RESIDENCE INN	941 W GROVE AV	117.00	22	.19	-0.56
ROADRUNNER MOTEL	2066 W MAIN ST	23.00	34	1.43	0.68
SAN DEE MOTEL	6649 E MAIN ST	12.00	1	.08	-0.67

SAN JO MOTEL	524 W MAIN ST	14.00	35	2.50	1.75
SELECT SUITES	960 W SOUTHERN AV	205.00	161	.76	0.01
SHERATON MESA HOTEL#	200 N CENTENNIAL WA	268.00	108	.40	-0.35
SIERRA MADRE (SELECT SUITES)	900 N COUNTRY CLUB DR	112.00	146	1.30	0.55
SLEEP INN#	6347 E SOUTHERN AV	84.00	25	.29	-0.46
STARLITE MOTEL	2710 E MAIN ST	42.00	40	.93	0.18
SUNLAND	2602 E MAIN ST	25.00	88	3.20	2.45
SUPER 8 MOTEL	1550 S GILBERT RD	72.00	45	.63	-0.13
SUPER 8 MOTEL (Main St.)	6733 E MAIN ST	60.00	29	.48	-0.27
SUPER 8 TOWN CENTER	3 E MAIN ST	62.00	22	.35	-0.40
TRAILS WEST LODGE	6502 E MAIN ST	28.00	19	.68	-0.07
TRAVALEERS MOTEL	836 W MAIN ST	28.00	35	1.18	0.43
TRAVELODGE	22 S COUNTRY CLUB DR	39.00	22	.56	-0.19
TRAVELODGE SUITES	4244 E MAIN ST	76.00	37	.49	-0.26
TRI CITY INN	1504 W MAIN ST	26.00	38	1.38	0.63
VILLAGE MOTEL	2130 W MAIN ST	21.00	100	4.67	3.92
WESTMAIRE MOTEL	5414 E MAIN ST	42.00	11	.26	-0.49
		5232.00	3971	0.75	

Mobil Homes and RV Parks

Calls for Service for the Year - 1999

NOTE: These parks are classified in two areas: 1) FAMILY PARKS (those that allow children) and 2) SENIOR PARKS that limit residents to those being above a certain age.

Definitions

CFS: Calls for Service - (This does NOT necessarily indicate a crime occurred - only that a police interaction occurred).

Units: Number of housing units in the park.

Type: Type of Park (Family or Senior).

Ratio: Number of CFS per unit.

Level: Variation above or below the Citywide CFS ratio.

* = Complex is a member of the Crime-Free Mobile-Housing Program

= Complex participates (not certified) in Crime-Free Mobile-Housing Program.

Citywide Ratio for 1999 for FAMILY PARKS ONLY: 1.06						
<u>NAME</u>	<u>ADDRESS</u>	<u>UNITS</u>	<u>TYPE</u>	<u>CFS</u>	<u>RATIO</u>	<u>LEVEL</u>
ASPENWOOD MOBILE HOME PARK -*	245 S 56TH ST	269	Family	187	.70	-0.36
BEVERLY TRAILER COURT	26 S BEVERLY	38	Family	12	.33	-0.73
BONDS TRAILER PARK	644 W MAIN ST	123	Family	152	1.24	0.18
CASA ENCANTA MOBILE HOME PARK	1365 S COUNTRY CLUB DR	100	Family	277	2.77	1.71
CIBOLA MOBILE HOME PARK - *	2249 W MAIN ST	54	Family	54	1.00	-0.06
CLUFF'S MOBILE HOME PARK	52 S BEVERLY	39	Family	36	.92	-0.14
COUNTRY CLUB VILLAGE	2060 N CENTER ST	492	Family	738	1.50	0.44
DESERAMA MOBILE RANCH	2434 E MAIN ST	138	Family	37	.27	-0.79
GREEN ACRES TRAILER PARK	2052 W MAIN ST	75	Family	5	.07	-0.99
HERITAGE CIRCLE	2511 E MCKELLIPS RD	24	Family	7	.29	-0.77
JOSHUA TREE MOBILE HOME PARK	1527 N GREENFIELD RD	19	Family	24	1.26	0.20
KAY BEE MOBILE VILLA	130 E MCKELLIPS RD	106	Family	92	.87	-0.19
LA CASITA MOBILE HOME PARK	425 E MCKELLIPS RD	113	Family	78	.69	-0.37
M & M MOBILE HOME PARK - *	320 E MCKELLIPS RD	246	Family	105	.43	-0.63
MARK PARK	625 W MCKELLIPS RD	381	Family	580	1.52	0.46
MESA GARDENS MOBILE HOME PARK	1024 W MAIN ST	98	Family	107	1.09	0.03
MESA GRANDE TRAILER RANCH	2912 E MCKELLIPS RD	110	Family	125	1.14	0.08
MESA LODGE MOBILE HOME PARK	235 W SOUTHERN AV	187	Family	236	1.26	0.20
PARADISE PALMS TRAVEL RESORT	1608 E MAIN ST	80	Family	29	.36	-0.70
REDWOOD GARDENS - *	2207 W MAIN ST	44	Family	80	1.82	0.76
ROYAL PALM VILLAGE (FALCON EAST) - #	342 S 40TH ST	74	Family	85	1.15	0.09
SHADY GROVE TRAILER PARK	1561 E MAIN ST	62	Family	17	.27	-0.79
WEST MAIN TRAILER COURT	835 W MAIN ST	43	Family	76	1.77	0.71
WINTERCOVE PARK	549 E MCKELLIPS RD	115	Family	58	.50	-0.56

Citywide Ratio for 1999 for SENIOR PARKS ONLY: 0.09						
ALMA GARDENS	530 S ALMA SCHOOL RD	112	Senior	17	.15	0.06
AMBASSADOR DOWNS	2345 E MAIN ST	146	Senior	21	.14	0.05
APACHE WELLS RV RESORT	2656 N 56TH ST	320	Senior	20	.06	-0.03

APACHE WEST MOBILE VILLAGE	1035 W MAIN ST	73	Senior	36	.49	0.40
AZ & CO TRAVEL TRAILER RESORT	4220 E MAIN ST	328	Senior	25	.08	-0.01
BRENTWOOD MOBILE MANOR	120 N VAL VISTA DR	272	Senior	36	.13	0.04
BRENTWOOD SOUTHERN MH PARK - *	8103 E SOUTHERN AV	343	Senior	38	.11	0.02
BRENTWOOD WEST	3104 E BROADWAY RD	350	Senior	29	.08	-0.01
BROADMOR PARK	2601 E ALLRED AV	42	Senior	1	.02	-0.07
CASTILLO NUEVO - *	3300 E BROADWAY RD	302	Senior	30	.10	0.01
CITRUS GARDENS MOBILE HOME PARK - *	4065 E UNIVERSITY DR	458	Senior	82	.18	0.09
CITRUS GROVE TRAVEL COURT - *	1007 W MAIN ST	73	Senior	15	.21	0.12
CONQUISTADOR VILLAGE	2528 E MCKELLIPS RD	176	Senior	39	.22	0.13
CORONADO MOBILE HOME PARK	2700 E ALLRED AV	98	Senior	16	.16	0.07
COUNTRY COUSINS MOBILE HOME PARK - *	61 W SOUTHERN AV	85	Senior	25	.29	0.20
CRESCENT RUN	8500 E SOUTHERN AV	588	Senior	24	.04	-0.05
CYPRESS ESTATES	3300 E MAIN ST	160	Senior	2	.01	-0.08
EL MAR TRAILER COURT	3247 E MAIN ST	24	Senior	17	.71	0.62
EL MIRAGE MOBILE HOME PARK	305 S VAL VISTA DR	436	Senior	45	.10	0.01
FIESTA TRAVEL TRAILER PARK	3811 E UNIVERSITY DR	336	Senior	18	.05	-0.04
FOUNTAINS EAST MOBILE HOME PARK	303 S RECKER RD	279	Senior	16	.06	-0.03
GARDEN SPOT	44 S BARKLEY & 32 S BARKLE	60	Senior	41	.68	0.59
GLENN MOBILE HOME PARK	919 E MAHONEY AV	30	Senior	18	.60	0.51
GOODLIFE TRAVEL TRAILER RESORT	3403 E MAIN ST	1184	Senior	54	.05	-0.04
HACIENDA DE LA VALENCIA	201 S GREENFIELD RD	362	Senior	34	.09	0.00
HOLIDAY VILLAGE MOBILE HOME PARK	701 S DOBSON RD	684	Senior	110	.16	0.07
KARMELLA MOBILE HOME PARK	730 S COUNTRY CLUB DR	108	Senior	26	.24	0.15
LAS PALMAS MOBILE HOME PARK	215 N POWER RD	536	Senior	53	.10	0.01
MESA DUNES MOBILE HOME PARK	7807 E MAIN ST	98	Senior	39	.40	0.31
MESA MOBILE VILLAGE - *	2701 E ALLRED AV	201	Senior	18	.09	0.00
MESA REGAL RV RESORT	4700 E MAIN ST	2000	Senior	101	.05	-0.04
MESA SHADOWS MOBILE HOME PARK - *	205 S HIGLEY RD	306	Senior	32	.10	0.01
MONDAK MOBILE HOME PARK	101 N 38TH ST	148	Senior	56	.38	0.29
MONTE VISTA VILLAGE	8865 E BASELINE RD	832	Senior	41	.05	-0.04
NEW HOPE MOBILE HOME PARK	5933 E MAIN ST	172	Senior	27	.16	0.07
ORANGWOOD SHADOWS RV RESORT - #	3165 E UNIVERSITY DR	474	Senior	37	.08	-0.01
PALM GARDENS MOBILE MANOR	2929 E MAIN ST	715	Senior	58	.08	-0.01
PALMAS DEL SOL	6209 E MCKELLIPS RD	467	Senior	48	.10	0.01
PARK PLACE RV RESORT - *	306 S RECKER RD	288	Senior	22	.08	-0.01
SOUTHERN PALMS MOBILE HOME PARK - #	29 W SOUTHERN AV	66	Senior	27	.41	0.32
SUIT YOU	1531 E MAIN ST	20	Senior	9	.45	0.36
SUN DIAL TERRACE	2121 N CENTER	216	Senior	1	.00	-0.09
SUN REST	2551 E MCKELLIPS RD	78	Senior	14	.18	0.09
SUN RISE VISTA MOBILE HOME PARK	300 S VAL VISTA DR	291	Senior	35	.12	0.03
SUNLIFE TRAVEL TRAILER RESORT	5055 E UNIVERSITY DR	761	Senior	56	.07	-0.02
SUNRISE VILLAGE MOBILE HOME PARK	5402 E MCKELLIPS RD	231	Senior	29	.13	0.04
THE RESORT (SUPERSTITION COUNTRY RV	101 S ELLSWORTH RD	792	Senior	23	.03	-0.06
TIFFANY RV RESORT	3265 E MAIN ST	42	Senior	22	.52	0.43
TOWER POINT TRAVEL TRAILER RESORT	4860 E MAIN ST	1112	Senior	69	.06	-0.03
TRAIL RIDERS HOLIDAY PARK	2460 E MAIN ST	228	Senior	19	.08	-0.01
TRAILER VILLAGE	3020 E MAIN ST	835	Senior	78	.09	0.00
TWIN PALMS TRAVEL TRAILER PARK	2225 E MAIN ST	13	Senior	1	.08	-0.01
VAL VISTA VILLAGE	233 N VAL VISTA DR	1016	Senior	62	.06	-0.03
VALLE DE ORO	1452 S ELLSWORTH RD	1802	Senior	61	.03	-0.06